

Special equipment

Content

	Page
15. 1 General information	1052
15. 2 Overview	1053
15. 3 Retractable bottom seals	1054 - 1055
15. 4 Security bolts	1056
15. 5 Lead inlay and laminated aluminium inlay	1057
15. 6 Door viewer	1058
15. 7 Electrical strikes	1059 - 1060
15. 8 Security equipment	1061
15. 9 Electromechanical blocking device	1062
15.10 Door bolting device	1063 - 1064
15.11 Electrical lock surveillance systems	1065
15.12 Power supplies	1066 - 1102
15.13 Kick and push plates	1103
15.14 Ventilation grille and mail slot	1104
15.15 Grounding strap, stainless steel strike plate	1105
15.16 Electromagnets	1106

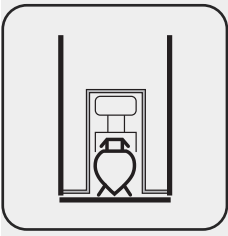

Special equipment

General information

Requirements

Schörghuber special doors can be equipped with and prepared for a great range of special equipment. Hereby a distinction is drawn between function-accordant equipment and requirement-accordant special fittings and devices.

Depending on the door function Schörghuber doors are by default equipped with certain fittings and equipment features, as for example door closers, locks, handles as well as hinges. These are described in detail in the according chapters.

Furthermore, depending on the door function, special equipment as for example retractable bottom seals for Smoke-Protection- and Sound-Insulation-Doors or lead inlays for Radiation-Protection-Doors is already accounted for.

Function-accordant special equipments:

- Bottom seal (standard for Smoke-Protection and Sound-Insulation-Doors)
- Security bolts in the hinge edge (up to 5 pieces)
- Lead inlay up to 4 mm lead equivalent value (for Radiation-Protection-Doors)
- Laminated aluminium inlay for climate category III
- Alarm-wire inlay
- High-frequency insulation (Faraday cage)

Requirement-accordant special equipments:

- Door viewer
- Electrical strike
- Security equipment (block lock, bolt contact, magnetic contact, etc.)
- Electronic control and surveillance systems
- Escape route protection systems
- Cable channel and cable transition
- Door bolting device
- Kick plate and edge guard
- Ventilation grille
- Mail slot
- Grounding strap
- Stainless steel strike plate in steel frame
- Electromagnets

For the installation of additional equipment applies that it must not interfere with the door function, e.g. Fire- or Smoke-Protection-Doors etc. On site modifications of Fire- and Smoke-Protection-Doors are subject to restrictions of the DIBt in Berlin and are published regularly. ➔ See index, chapter 2

Every door manufacturer has to provide according test certificates and verifications for the use of special equipments for e.g. Fire- or Smoke-Protection-Doors.

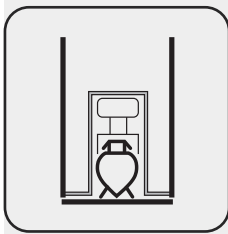

Special equipment

Combinations

Overview

15.2

Wooden special doors

Special equipment	Door function																		
	T 30	T 60	T 90	T 120	RS	SD 32	SD 37	SD 42	SD 45	SD 48	SD 50	WK 2	WK 3	WK 4	PB	DT	NT	VT	
Bottom seal	○	○	○	○	●	●	●	●	●	●	●	○	○	○	○	○	○	○	○
Security bolts	○	○	○	○	○	○	○	○	○	○	○	○	●	●	○	○	○	○	○
Lead inlay (door leaf weight max. 200 kg) Lead equivalent value 1, 1.5 or 2 mm	○				○														
Lead inlay (Türgewicht max. 200 kg) Lead equivalent value 1 bis 4 mm						○	○	○	○		○	○	○	○	●				
Lead inlay in steel frames	○				○	○	○	○	○		○	○	○	○	○				
Laminated aluminium inlay Door leaf climate category III	○		○	○	○	○	○	○	○	○	○	○	○	○					○
Door viewer	○	○	○	○	○	○	○	○	○	○	○	○	○	○			○		○
Electrical strike	○	○	○		○	○	○	○	○	○	○	○	○		○	○			○
Fixture for block lock / blocking device	○	○	○	○	○	○	○	○	○	○	○	○	○	○	○	○			○
Bolt contact	○	○	○	○	○	○	○	○	○	○	○	○	○	○	○	○			○
Magnetic contact	○	○	○	○	○	○	○	○	○	○	○	○	○	○	○	○			○
Electr. control and monitoring system	○	○	○	○	○	○	○	○	○	○	○	○	○	○	○	○			○
Escape door opener 331 with latch lock 807-12	○	○	○		○	○	○	○	○	○	○	○	○	○	○	○			○
Cable channel, cable transition	○	○	○	○	○	○	○	○	○	○	○	○	○	○	○				○
Door bolting device	○	○	○	○	○	○	○	○	○	○	○	○	○	○	○	○			○
Kick plate, edge guard	○	○	○	○	○	○	○	○	○	○	○	○	○	○	○	○	○	○	○
Ventilation grille / mail slot																		○	○
Grounding strap	○	○	○	○	○	○	○	○	○	○	○	○	○	○	○	○	○	○	○
Stainless steel strike plate (steel frame)	○	○	○	○	○	○	○	○	○	○	○	○	○	○	○	○	○	○	○
Alarm-wire inlay	○	○	○	○	○	○	○	○	○		○	○	○	○	○	○			○
High-frequency insulation	○	○	○	○	○	○	○	○	○		○	○	○	○	○	○			○

○ On request ● Standard

- T 30** = T 30 Fire-Protection
- T 60** = T 60 Fire-Protection
- T 90** = T 90 Fire-Protection
- T 120** = T 120 Fire-Protection
- RS** = Smoke-Protection
- SD 32** = Sound-Insulation Rw,P 32 dB
- SD 37** = Sound-Insulation Rw,P 37 dB
- SD 42** = Sound-Insulation Rw,P 42 dB
- SD 45** = Sound-Insulation Rw,P 45 dB

- SD 48** = Sound-Insulation Rw,P 48 dB
- SD 50** = Sound-Insulation Rw,P 50 dB
- WK 2** = Burglar-Protection WK 2
- WK 3** = Burglar-Protection WK 3
- WK 4** = Burglar-Protection WK 4
- PB** = Radiation-Protection
- DT** = Bullet-Resistant M 3
- NT** = Wet Room
- VT** = Solid Core

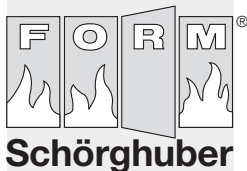

Schörhuber

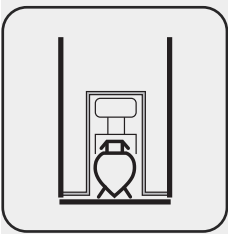

Special equipment

15.3

Requirement-accordant equipment

Retractable bottom seals

field of applications

All Schörghuber special doors (except Wet Room Doors) can be equipped with retractable bottom seals.

Smoke-Protection-Doors, approved according to DIN 18095, have to be equipped with a bottom seal. The installation of retractable bottom seals for Fire- and Smoke-Protection-Doors is only permitted for the door manufacturer. Fire-Protection-Doors with bottom seal must not be shortened on site.

If doors are equipped with retractable bottom seals in order to meet sound-insulation requirements, the use of thresholds (e.g. aluminum rails) and a floor disjunction (disjunction joint) is recommended. Carpets and also flat uneven floor coverings underneath the door leaf edge can seriously decrease the sound-deadening function of the door set.

Wooden special doors

Retractable bottom seal

1-leaf doors

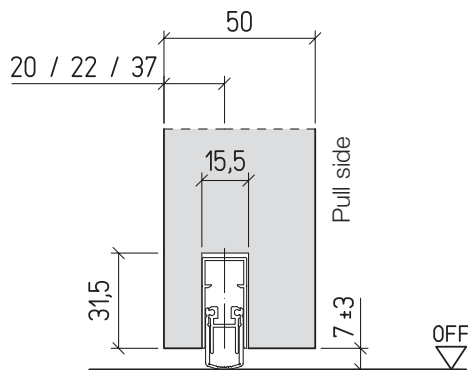

20 mm for rebated door leaf
 22 mm for unrebated door leaf
 37 mm for unrebated door leaf with jamb rebate

2-leaf doors

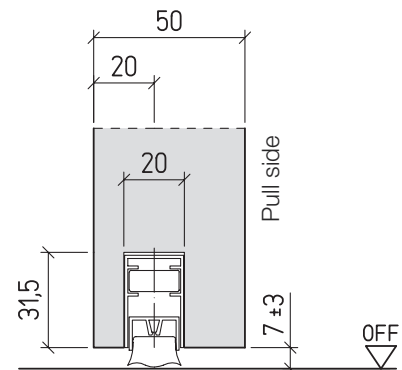

Sound-Insulation $R_{w,P}$ 37 dB

Type 5 N, 25 N

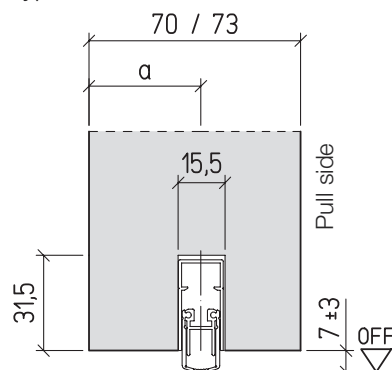

a = Tst 70: 37 mm for rebated door leaf
 43 mm for unrebated door leaf with jamb rebate
 45 mm for unrebated door leaf with jamb rebate
 38 mm for unrebated door leaf with double jamb rebate

a = Tst 73: 44 mm for unrebated door leaf with jamb rebate and DIN-lock
 42 mm for unrebated door leaf with jamb rebate and RR-lock
 37 mm for rebated door leaf and DIN-lock
 35 mm for rebated door leaf and RR-lock

Sound-Insulation $R_{w,P}$ 37 dB

Type 6 N, 27 N

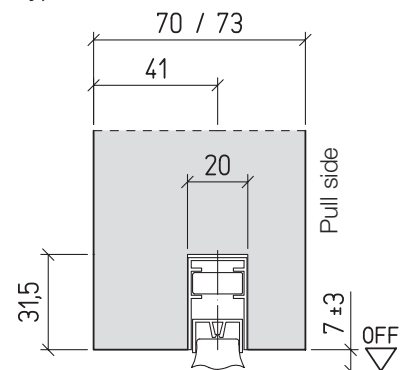

¹⁾ 39 for RR-lock

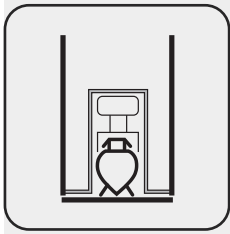

Special equipment

15.3

Requirement-accordant equipment

Retractable bottom seals

Wooden special doors

Sound-Insulation $R_{w,P}$ 42 dB/45 dB

Type 5 N/6 N, 25 N

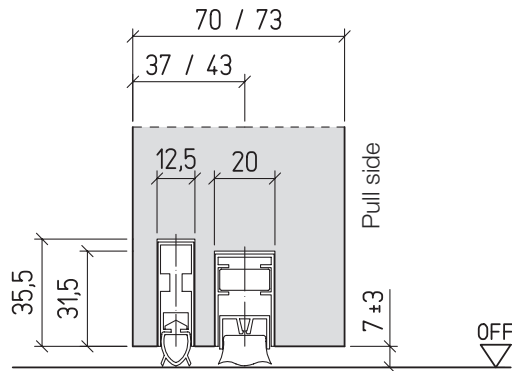

37 mm for 2-leaf door
37 mm for rebated 1-leaf door
43 mm for unrebated 1-leaf door

Sound-Insulation $R_{w,P}$ 48 dB

Type 17 N

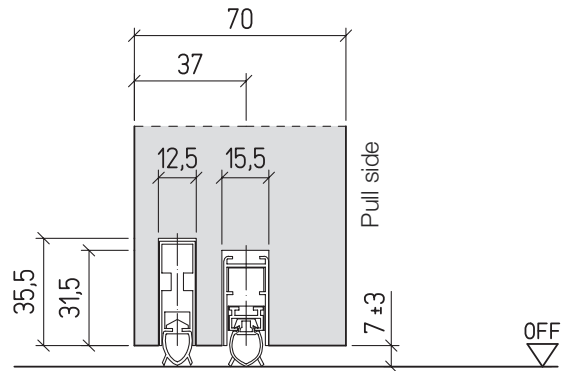

Sound-Insulation $R_{w,P}$ 32 dB and 37 dB

Type 10 N/20 N

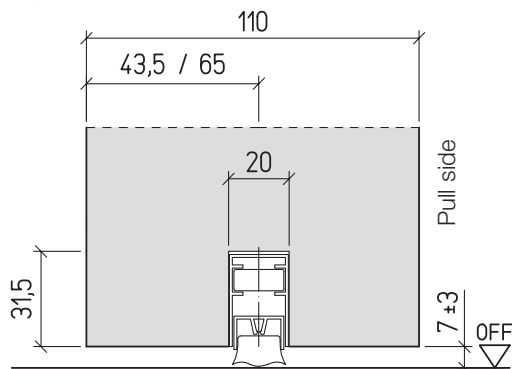

Sound-Insulation $R_{w,P}$ 42 dB

Type 10 N/20 N

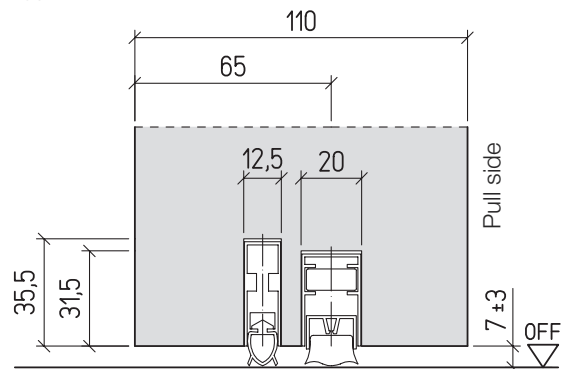

Sill seal with twin sealing strip

with threshold trim (aluminium)

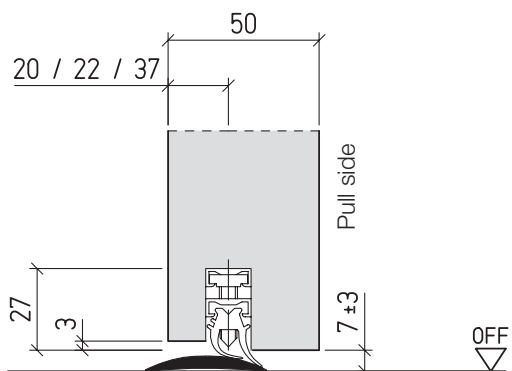

20 mm for rebated door leaf
22 mm for unrebated door leaf
37 mm for unrebated door leaf with jamb rebate

Configuration with disjunction of the screed or disjunction threshold

Position below the door leaf edge, from SD 37 on

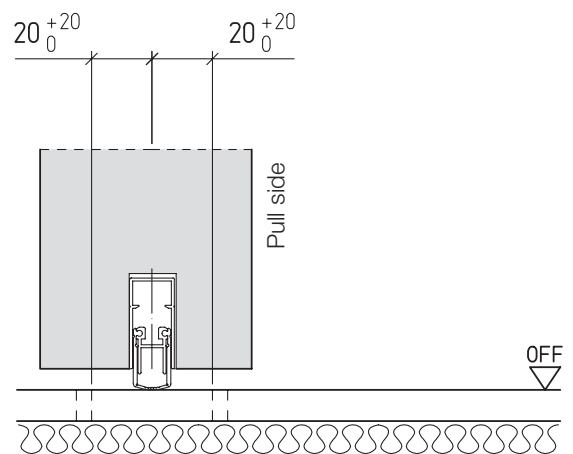

Schörhuber

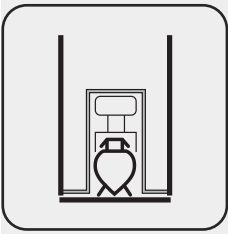

Special equipment

15.4

Requirement-accordant equipment

Security bolts

Wooden special doors

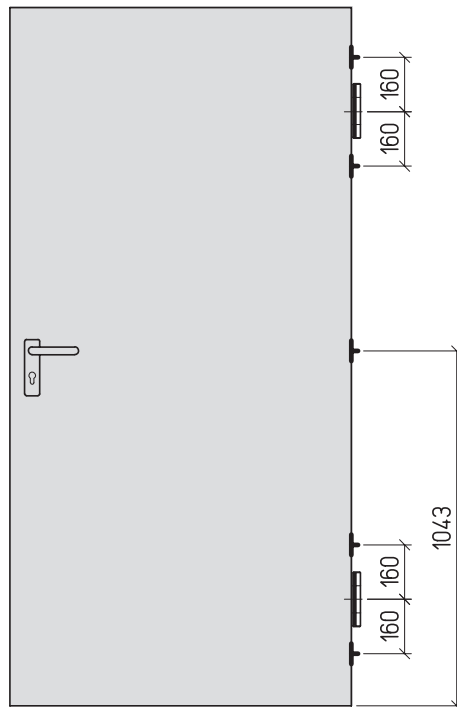

Security bolts

1-leaf door sets of the resistance class WK 2 (Burglar-Protection according to DIN V ENV 1627) can on request be equipped with up to 5 security bolts.

The configuration of the door sets with resistance class WK3 by default includes 5 security bolts.

Security bolts are available in galvanised or stainless steel configuration.

Security bolts

Door leaf

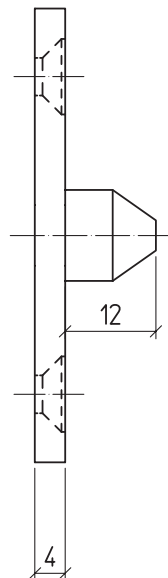

Counterpart

Wooden frame

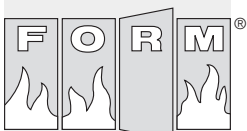
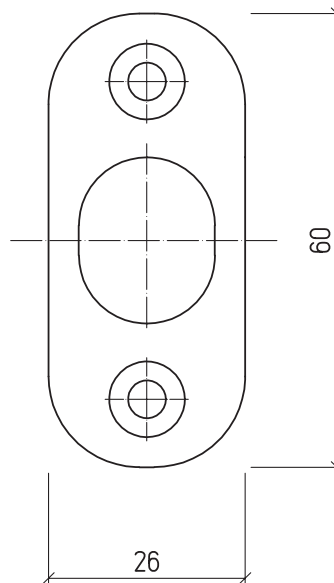

Schörghuber

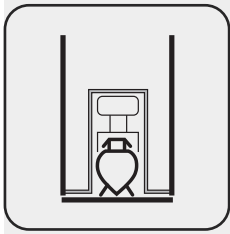

Requirement-accordant equipment

Lead inlay and laminated aluminium inlay

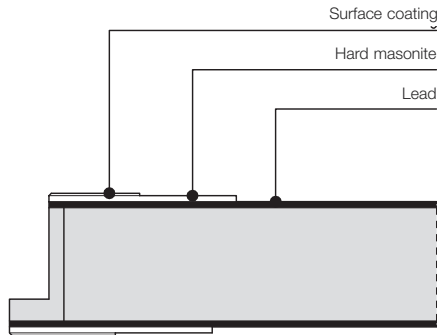

Lead inlay

Construction-conditioned a symmetrical door leaf assembly is necessary. The lead equivalent value of a Radiation-Protection-Door is determined through the adding of the thickness of the lead inlay on both sides of the door leaf. The door leaf weight is determined by the door type, the dimensions of the door, as well as the thickness of the lead inlay (approx. 13 kg/m² per mm lead inlay thickness). Hereby the door leaf weight is limited by the maximum bearing force of the door hinges.

The lead inlay is only available in defined material thicknesses. A Radiation-Protection-Door can be, in consideration of the maximum bearing force of the door hinges, equipped with the following lead inlays:

Lead equivalent values

- 1,0 mm (2 x 0,5 mm)
- 1,5 mm (2 x 0,75 mm)
- 2,0 mm (2 x 1,0 mm)
- 3,0 mm (2 x 1,5 mm)
- 4,0 mm (2 x 2,0 mm)

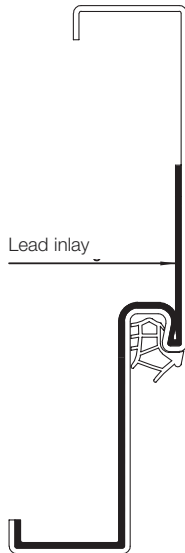

With regard to the radiation protection function for steel frames different possibilities, such as partial lead inlays or the use of radiation protection mortar, are available. ➔ Chapter 2.7

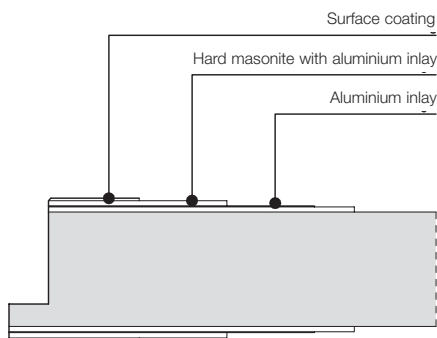

Laminated aluminium inlay

Except of a few door leaf constructions all Schörghuber special doors are available in climate category III configuration. Exceptions are the solid wood framed door and the combination with bullet-resistant function.

In order to resist extreme climate stress on both sides of the door leaf, the door construction is if necessary enhanced with an additional laminated aluminium inlay. The in the cover plates, symmetrically arranged, visible aluminum layers hinder the humidity passage and the affiliated shape distortion of the door leaf. The types 16 N and 26 N are classified in climate category III, even without additional laminated aluminium inlay.

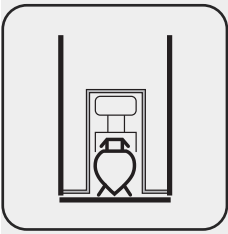

Special equipment

15.6

Requirement-accordant equipment

Door viewer

Schörghuber special doors are on request available with door viewer. Exceptions are Bullet-Resistant-Doors and Radiation-Protection-Doors.

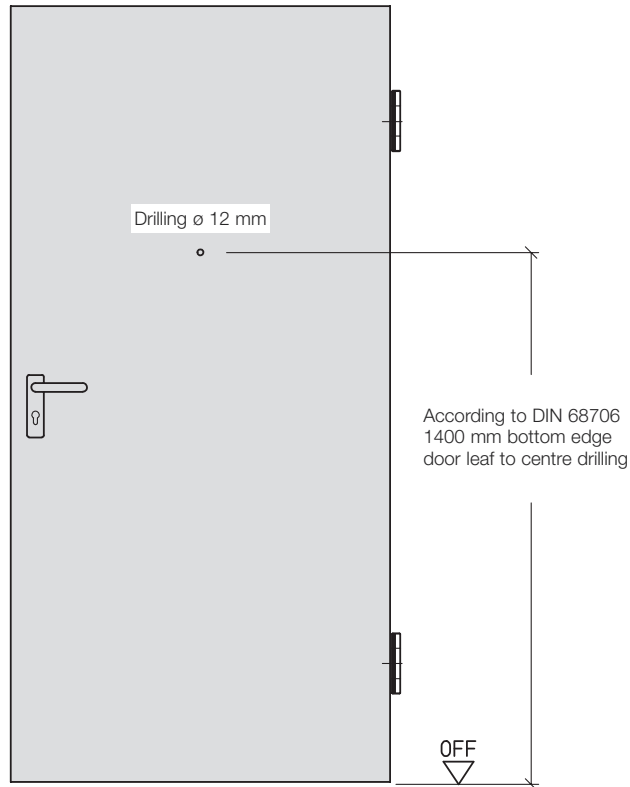

The lenses of the door viewer are available in different angles of vision. By default the angle of vision is 180°, on request the door viewers can be equipped with lenses of 200° angle of vision and covering cap.

The position of the door viewer is defined, according to DIN 68706, to a height of 1400 mm from the bottom edge of the door leaf to the centre of the drilling. Differing positions are available on request.

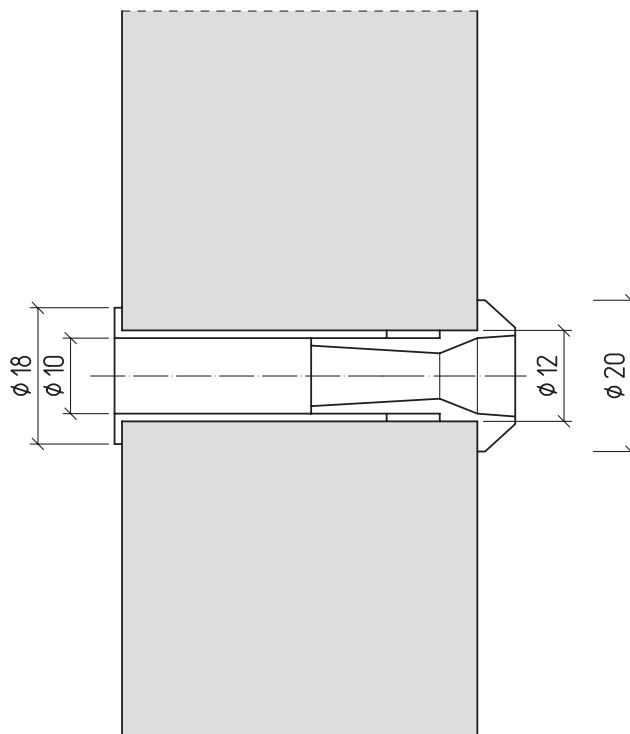

Wooden special doors

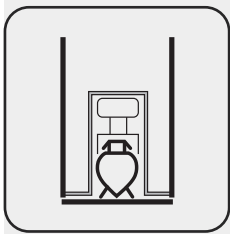

Special equipment

15.7

Requirement-accordant equipment

Electrical strikes for 1-leaf door sets

The use of electrical strikes offers the possibility to monitor and control the access to certain secured areas.

In general the door openers are divided in standby current door openers and operating current door openers. The latch of operating current door openers is released by triggering the electrical switch (current entry).

Fire- and Smoke-Protection-Doors can be equipped with operating current door openers only. This ensures that in the event of a blackout or a power off the door remains shut and therefore fulfils its function (to hinder the spreading of fire and smoke). A permanent unlocking of the electrical strike for Fire- and Smoke-Protection-Doors is therefore not permitted.

Only the manufacturer of Fire- and Smoke-Protection-Door sets is permitted to install an electrical door opener. A later installation of an electrical strike is only possible if a special strike plate was installed during the production of the frame. The necessary electrical strike can on request be supplied by Schörghuber.

The operating voltage is by default 24 volts, on request 12 volts. The door opener can be operated either with alternating current voltage (AC) or direct current voltage (DC), whereas alternating current voltage is, due to the greater opening force, recommended. On request Schörghuber offers a direct current voltage door opener which pulses the voltage in the opening moment and therefore reaches a great opening force even for direct current voltage.

Standby current door openers can only be operated as special equipment on Fire- and Smoke-Protection-Door sets (escape route protection).

The equipment of electrical strikes with a feedback contact for lock surveillance of the door set is possible. The feedback contact shows if the the door leaf is shut or open.

Electrical strikes for Schörghuber door sets are also available in WK 2 / WK 3 configuration.

Wooden special doors

Steel frame

Displayed rebated, unrebrated analogue, standard with 35 mm face width

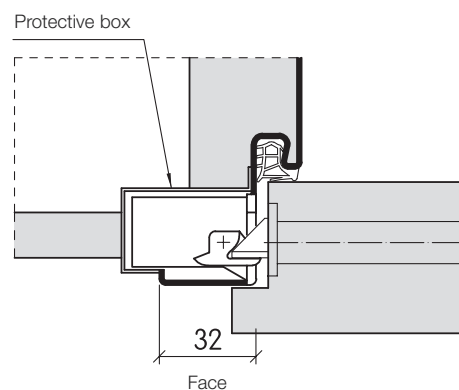
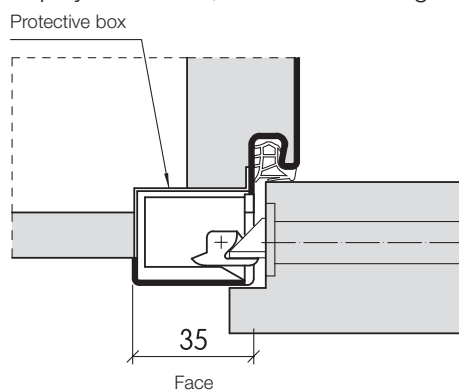

Wooden wrap-around frame

Wooden block frame analogue

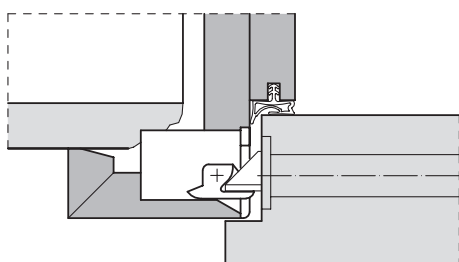

Solid wooden frame

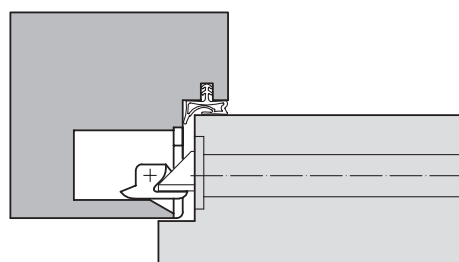

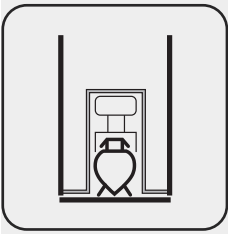

Special equipment

15.7

Requirement-accordant equipment

Electrical strikes 2-leaf door sets

Position of the electrical strike for the concealed shot-bolt lock BKS 1899

In combination with 2-leaf door sets electrical strikes can be installed on a special strike plate of the inactive leaf lock.

The cable can hereby exit the door leaf either concealed in the rebate (cable transition), or visible on the door leaf surface on pull or push side.

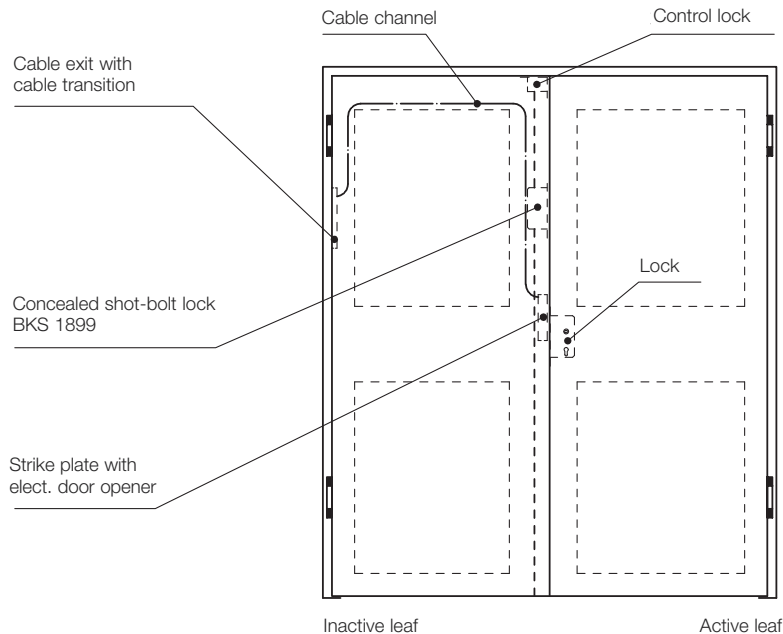

Integrated electrical strike for the shot-bolt lock BKS 2392 / 2397

In combination with a shot-bolt lock the electrical strike is integrated in the inactive leaf.

The cable can hereby exit the door leaf either concealed in the rebate (cable transition), or visible on the door leaf surface on pull or push side.

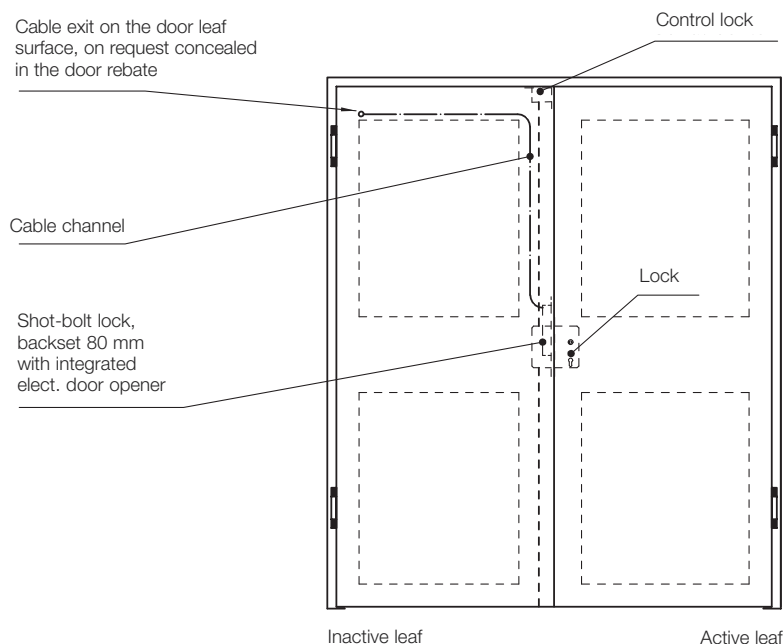

Wooden special doors

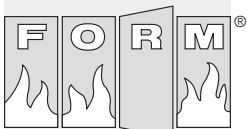

Schörghuber

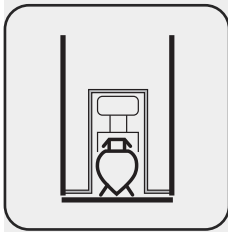

Requirement-accordant equipment

Security equipment

Block locks

Due to the fact that type and configuration of the to be installed block locks in a building project are usually specified, it is possible to prepare all Schörghuber special doors for on site provided models. For electrically operated block locks it is necessary to insert a cable channel in order to provide power supply.

Magnetic contact

Magnetic contacts (reed contacts) serve as surveillance and electrical monitoring of the door position, either open or shut. This is usually necessary in combination with control and surveillance systems. Schörghuber offers the displayed magnetic contacts as a standard solution. A preparation for on site provided magnetic contacts is possible as well.

Bolt contact

Bolt contacts serve as locking control mechanisms of the door leaf. Through this the bolted state of the door is visible in the control system. By default Schörghuber offers the bolt contacts "eff eff 878" and "LINK Type 100 13 31 C", a preparation for on site provided bolt contacts is possible as well.

For 2-leaf door sets the possibility, to monitor the bolting via a bolt contact, type Cherry, integrated in the shot-bolt lock of the inactive leaf, is given. On request also the closing state of the shot-bolt rod can be monitored via an additional switch contact on the upper strike plate.

Alternatively a surveillance of the active leaf lock is possible. ➔ Chapter 15.11

Bolt contact

eff eff 878
LINK 100 13 31 C

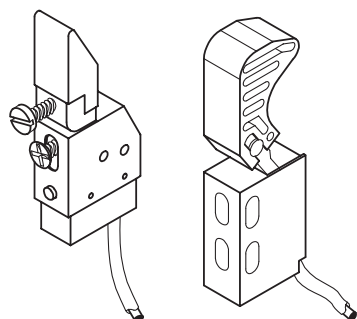

Magnetic contacts (dry reed contacts)

eff eff 10365
LINK 100 01 28 A/B

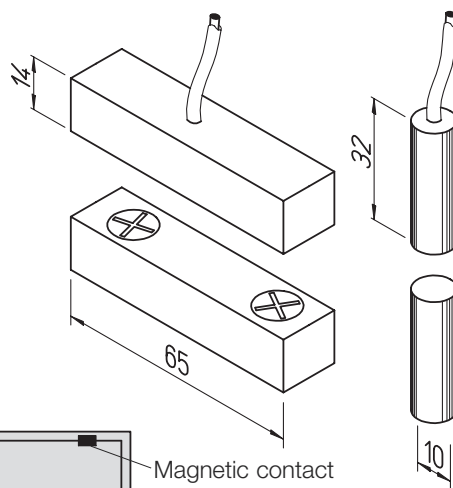

Position of the security equipment

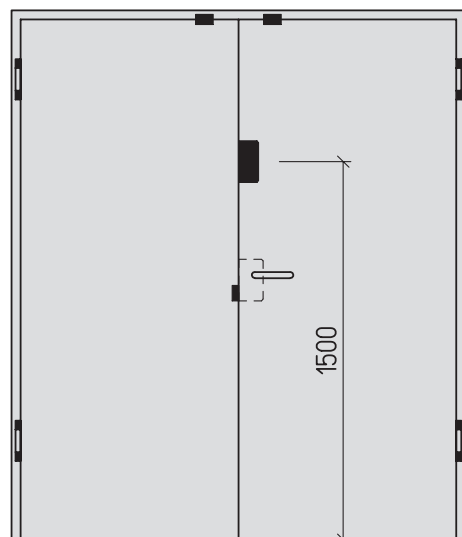

Inactive leaf

Active leaf

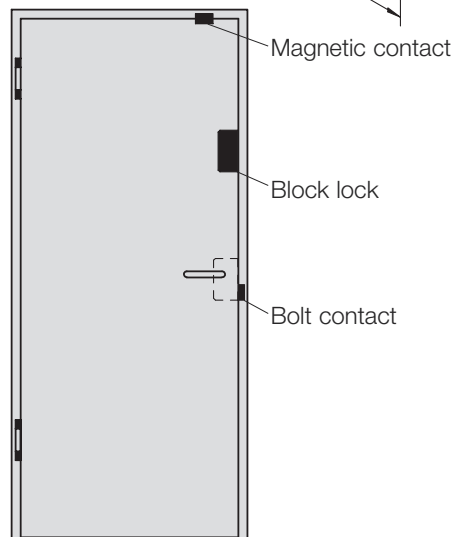

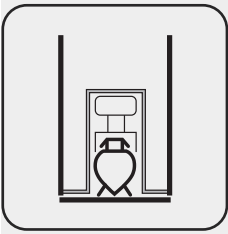

Special equipment

15.9

Requirement-accordant equipment

Electromechanical blocking device

With electromechanical blocking devices the access to the secured area of a burglar alarm system is prohibited. By activating the burglar alarm system the blocking device in the frame is bolted by electromechanically throwing a bolt in the according counter- / closure part.

Electromechanical blocking devices are not permitted on escape doors!

Schörghuber offers to prepare 1- and 2-leaf door sets, also Fire- and Smoke-Protection-Door sets, for on site provided blocking devices. Hereby an adequate face width of the frame, depending on the type of the blocking device, has to be accounted for.

Wooden special doors

Position of the electromechanical blocking device

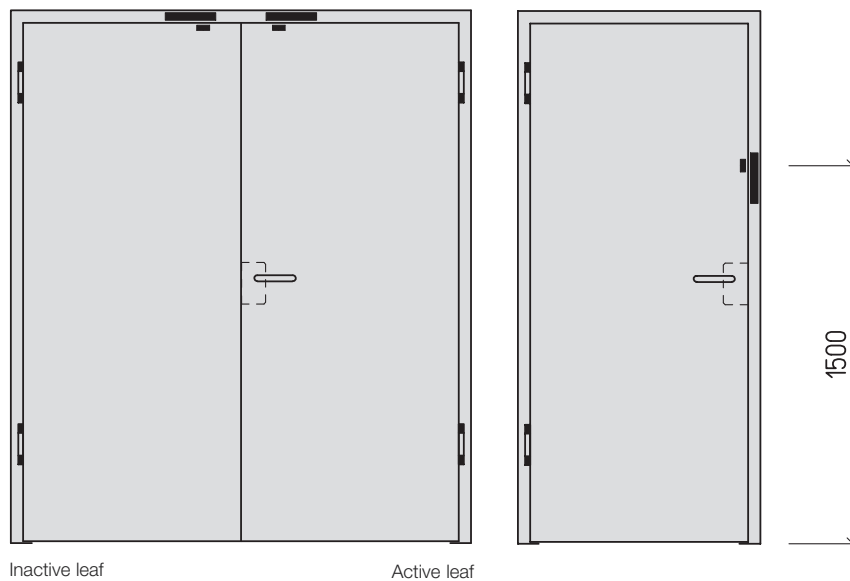

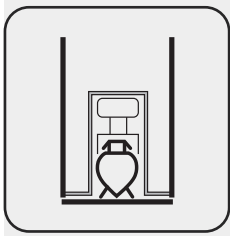

Special equipment

15.10

Requirement-accordant equipment

Door bolting device

Escape door opener with latch lock

eff eff 331 and 807-10 / DORMA TV 505-508 and TV-Z 510

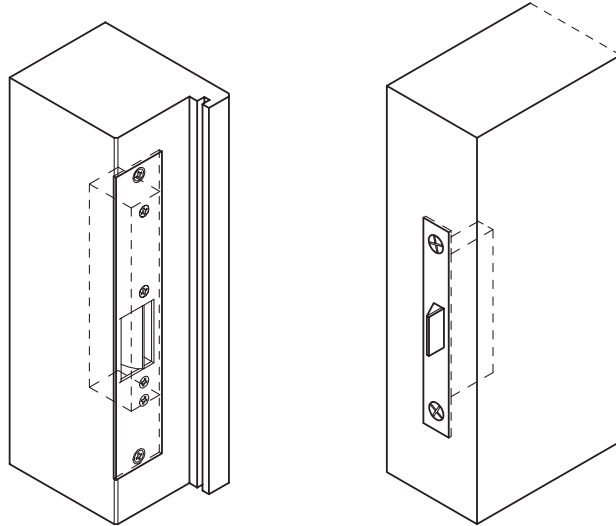

Wooden special doors

Position on the security equipment

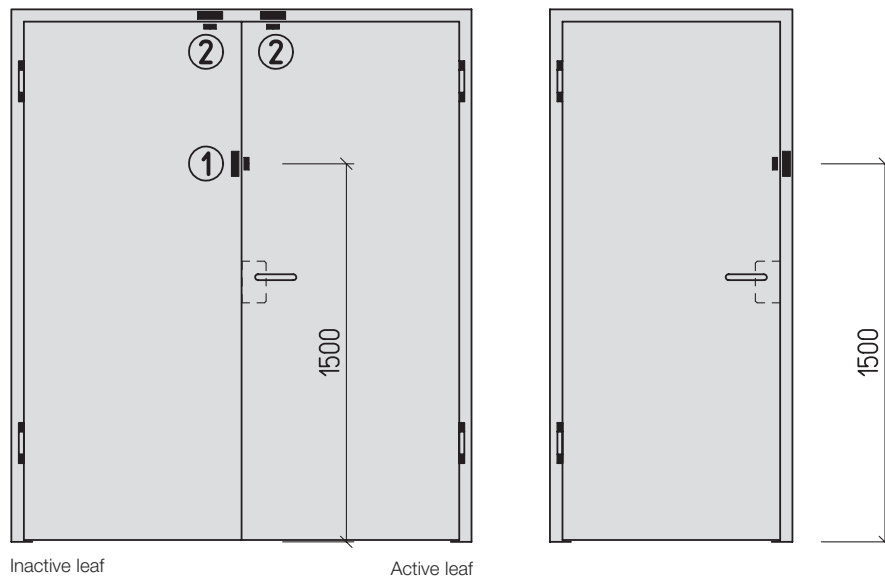

- ① Panic function on the active leaf, escape door opener at the meeting stiles
- ② Panic function on the active and inactive leaf, escape door openers on each top edge

Escape door opener

In order to prevent an unauthorised entering of doors in escape routes, a securing of the mostly with panic function equipped door sets is necessary. This possibility is offered by Schörghuber via the use of an additional escape door opener/closers in combination with a counter latch-lock. The door sets have to be integrated in the existing fire detection system and generally it is only possible to unlock the door via an installed door terminal.

Due to the fact that this system works in a standby current principle, a use in Fire- and Smoke-Protection-Doors as an addition to the mandatory main lock or a lock working with an operating current is permitted.

2-leaf door sets with full panic function have to be equipped with escape door opener/closers on both the top edge of the active and inactive leaf.

In order to be able to install an escape door opener/closers in a steel frame the **face width on the pull side** has to be extended to **45 mm**.

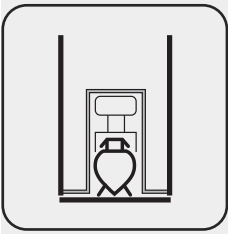

Special equipment

15.10

Requirement-accordant equipment

Door bolting device

field of applications of door bolting devices are for example escape and emergency routes. The doors of emergency exits, usually equipped with panic function, need to be protected against unauthorised entering from the outside. Various systems, which can be fastened on the door leaf or the frame, are suitable for this purpose.

Schörghuber offers, amongst others, the emergency exit securing systems DORMA Model TV 100 and GEZE MA 500. Frame and door leaf are prepared for the mounting of the door bolting device on the push side.

In the event of an emergency the door can be accessed by pressing an emergency switch (door terminal on handle height on the wall), which deactivates the bolting mechanism. The emergency switch has to be provided by the customer and installed according to the regulations.

Wooden special doors

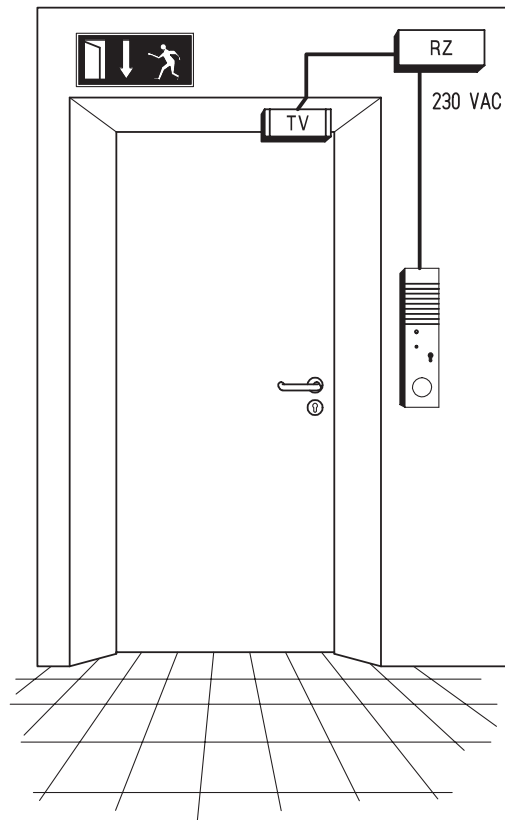

Standard installation

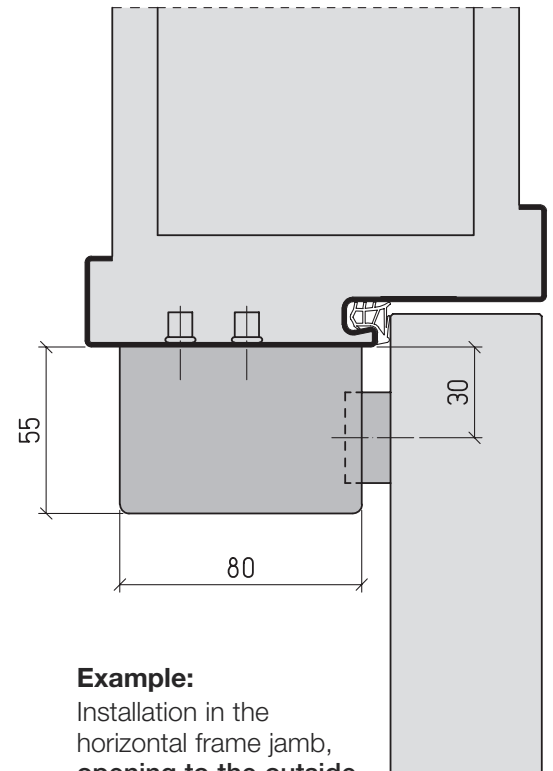

Example:

Installation in the horizontal frame jamb, opening to the outside

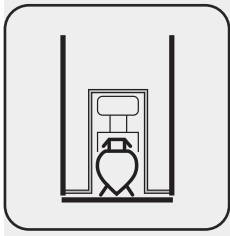

Special equipment

15.11

Requirement-accordant equipment

Electrical lock surveillance systems

Latch, bolt and follower surveillance

In order to monitor certain lock positions for access control systems, escape door surveillance systems, etc. it is recommended to install an integrated follower and/or latch and bolt surveillance.

Schörghuber door sets can be equipped for such surveillance systems. The accordingly prepared locks are inserted in the door leaf and a cable channel ensures that the power supply for the dry reed contacts via the magnet is connected.

The in the operating devices (bolt, latch, follower) inserted or built-on permanent magnets control the dry reed contacts within the lock.

A connection to common control systems is possible. Solutions for many different types of locks are available.

Wooden special doors

Follower surveillance

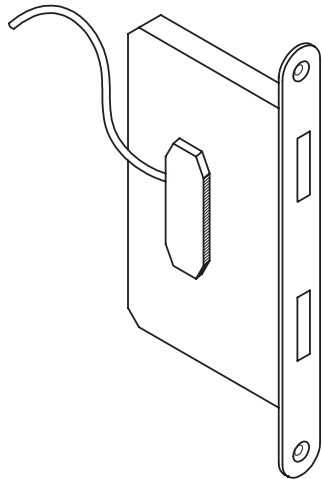

Latch and bolt surveillance

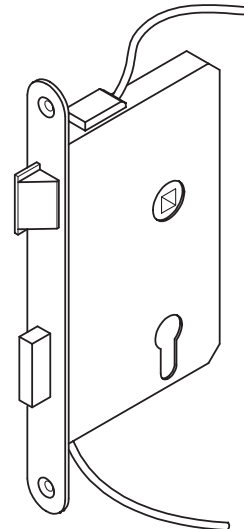

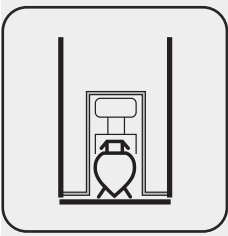

Requirement-accordant equipment

Power supplies

In order to control electrical devices within a door set, cables have to be fed from the outside. Current collectors in the frame can be cable-connected directly. Electrical devices embedded in the door leaf are connected via a cable transition. The following diagrams, concerning the position of the cable transition, are approximate measures, in order to obtain exact measures, please contact the factory.

All measurements refer to frame rebate dimensions respectively reference rebates for top panel and transom.

1. Cable transition

Each cable transition can only carry one cable. The following devices are controlled via the cable transition:

- Electrical strike in the inactive leaf
- Motor locks
- Block locks
- Blocking devices
- Door operators

1.1. Visible cable transition

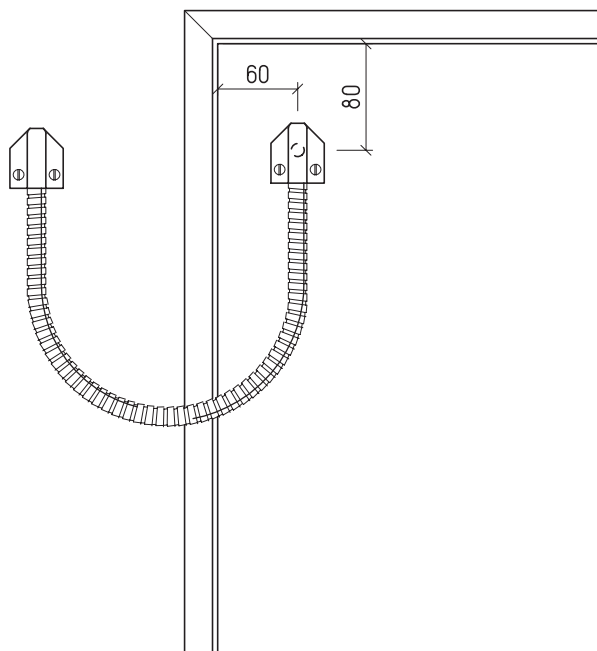

The cable transition is installed on the door leaf surface on either the pull or the push side above the top hinge. In order to prevent damages of the cable, a flexible metal tubing is recommended.

1.2 Concealed cable transition

The concealed cable transition is a visually appealing solution of the cable transition from the wall to door leaf. The cable exits in the door leaf rebate of the hinge edge, whereas the cable is guided to the frame in a flexible spiral. The cable transition is not visible if the door is closed.

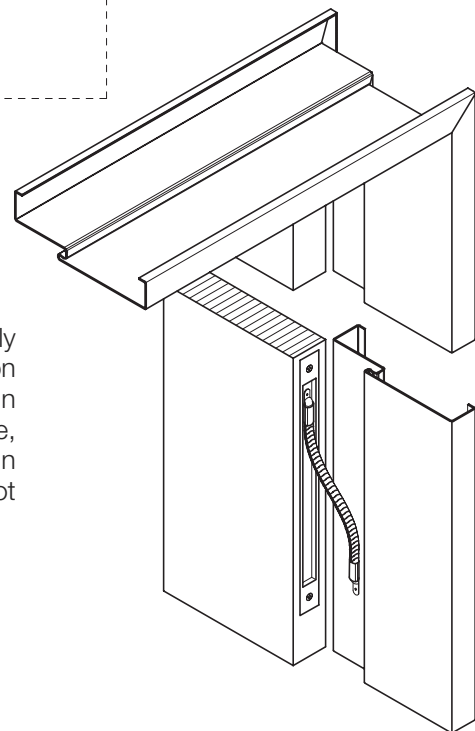

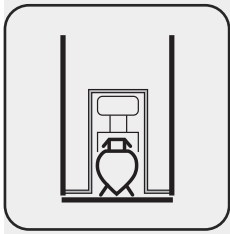

Special equipment

15.12

Requirement-accordant equipment

Power supplies

1.3 Cable transition for 1-leaf door

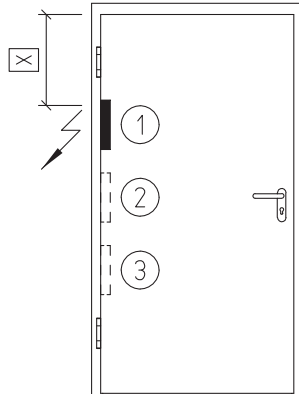

Cable transition Type	X-dimension for 2 hinges	X-dimension for 3 and more hinges
260	690	910
480	930	1150

① Standard position

② ③ On request

1-leaf door, lintel-high

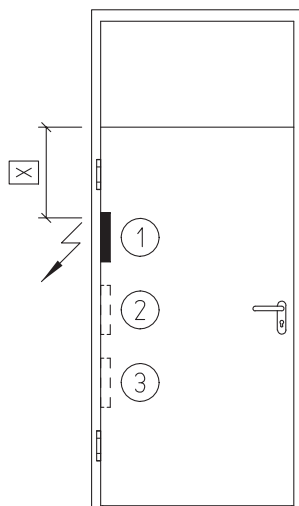

1-leaf door with top panel

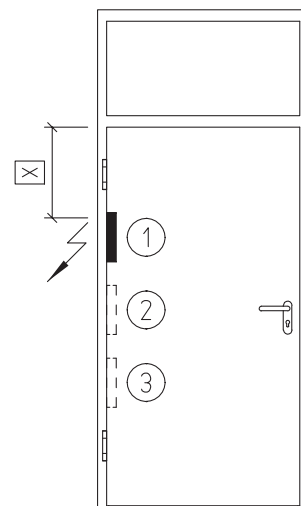

1-leaf door with transom

Wooden special doors

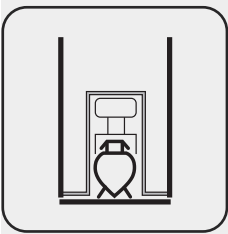

Special equipment

15.12

Requirement-accordant equipment

Power supplies

1.4 Cable transition for 1-leaf door with side panel

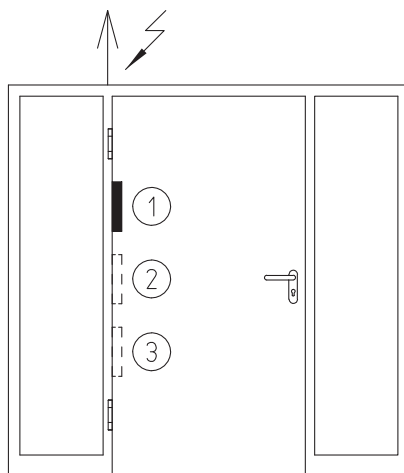

① Standard position

② ③ On request

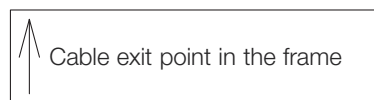

1-leaf door, lintel-high with side panel or with an unseparated solid wood construction

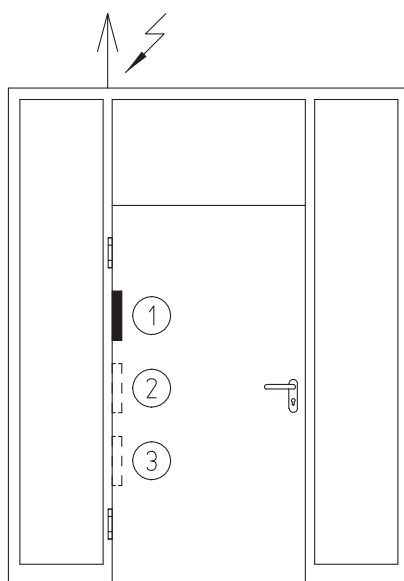

1-leaf door with top panel with side panel or with an unseparated solid wood construction

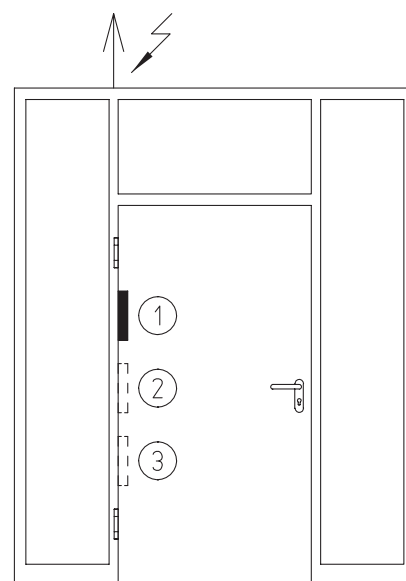

1-leaf door with transom with side panel or with an unseparated solid wood construction

Wooden special doors

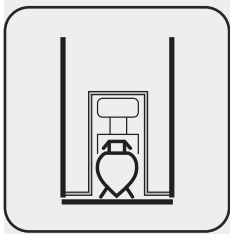

Special equipment

15.12

Requirement-accordant equipment

Power supplies

1.5 Cable transition for 2-leaf door

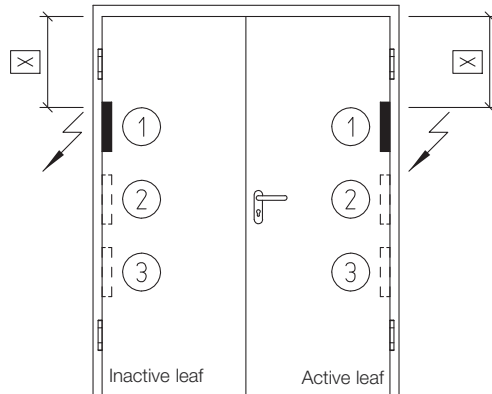

2-leaf door, lintel-high

Cable transition Type	X-dimension for 2 hinges	X-dimension for 3 and more hinges
260	690	910
480	930	1150

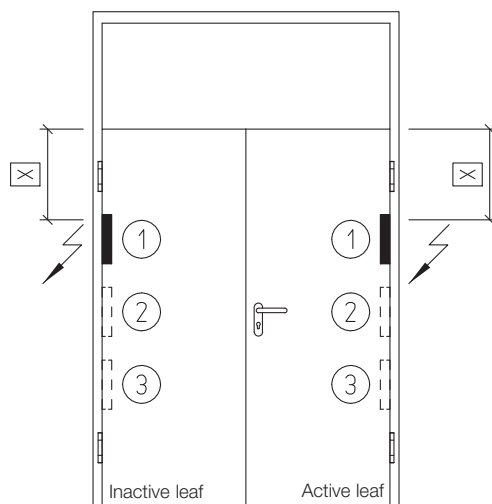

2-leaf door with top panel

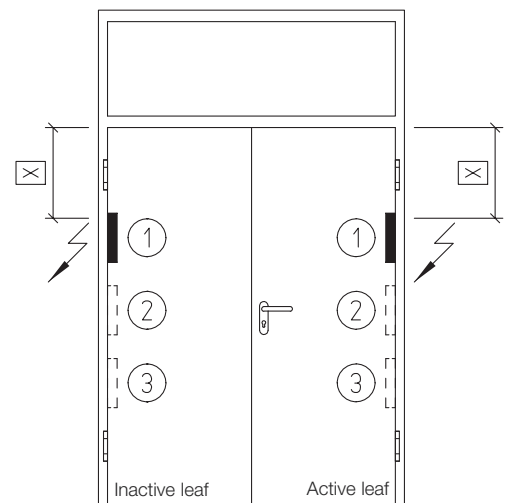

2-leaf door with transom

Wooden special doors

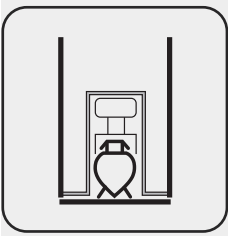

Special equipment

15.12

Requirement-accordant equipment

Power supplies

1.6 Cable transition for 2-leaf door with side panel

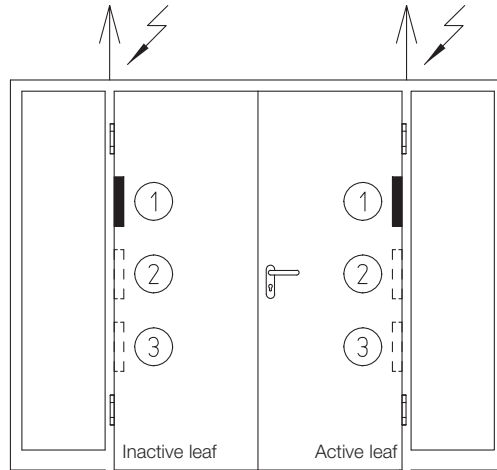

① Standard position

② ③ On request

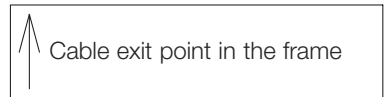

2-leaf door, lintel-high with side panel or with an unseparated solid wood construction

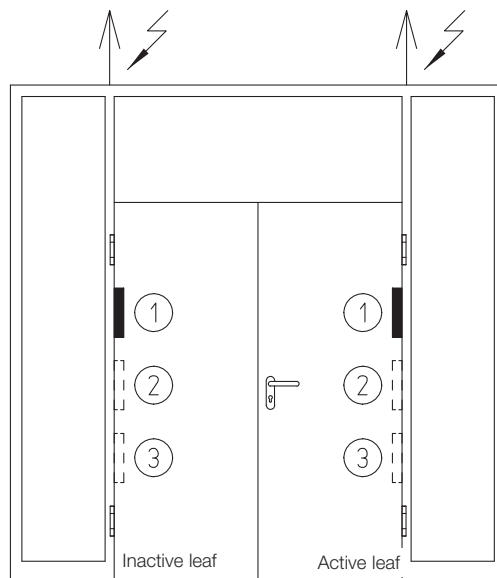

2-leaf door with top panel with side panel or with an unseparated solid wood construction

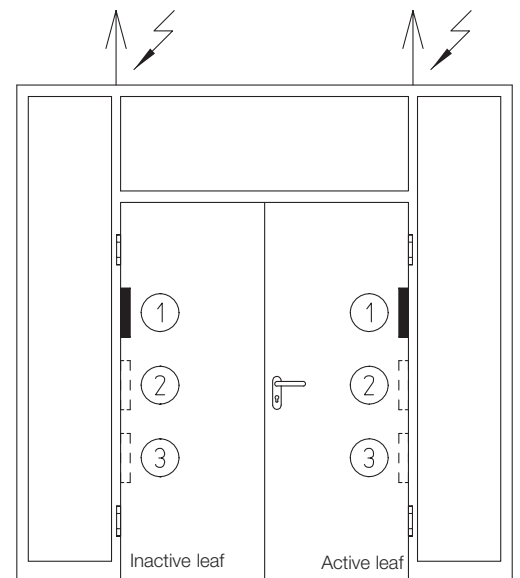

2-leaf door with transom with side panel or with an unseparated solid wood construction

Wooden special doors

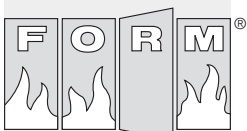

Schörghuber

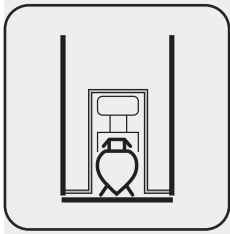

Requirement-accordant equipment

Power supplies

2. Electrical strikes 1-leaf door

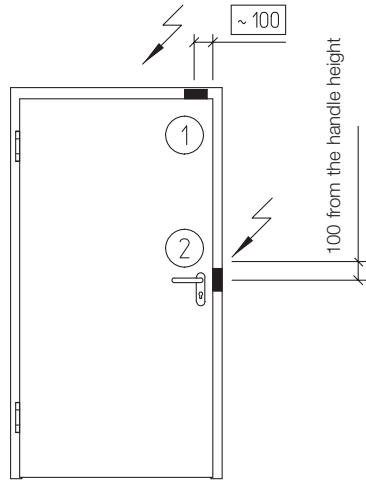

- ① Electrical strike on the upper bolting device (for locks with upper bolting device)
- ② Electrical strike on the main lock



1-leaf door, lintel-high

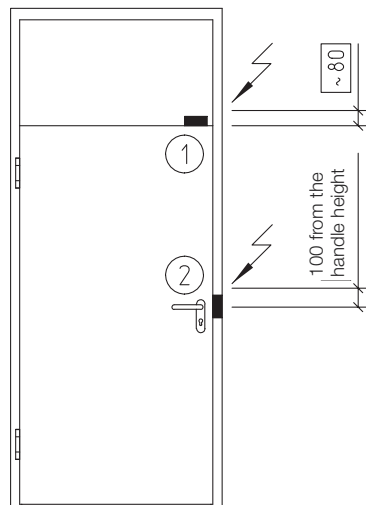

1-leaf door with top panel

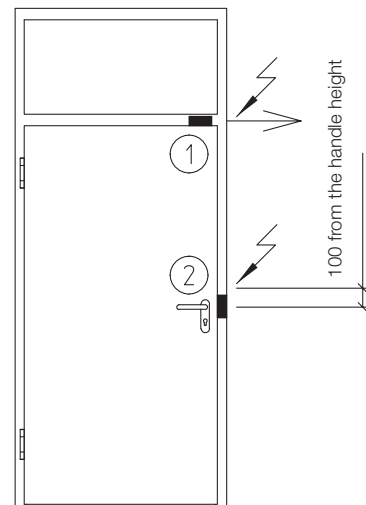

1-leaf door with transom

Attention: All measurements refer to frame rebate dimensions respectively reference rebates for top panel and transom.

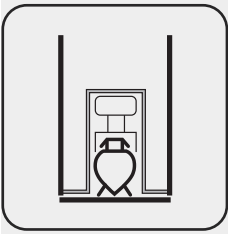

Requirement-accordant equipment

Power supplies

2.1 Electrical strikes 1-leaf door with side panel

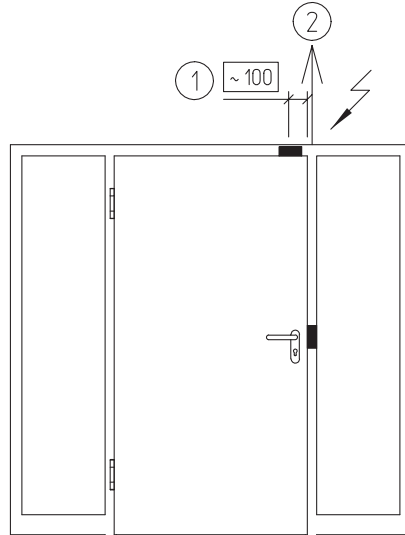

- ① Electrical strike on the upper bolting device (for locks with upper bolting device)
- ② Electrical strike on the main lock

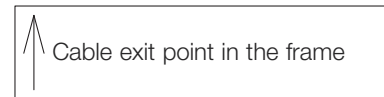

1-leaf door, lintel-high with side panel or with an unseparated solid wood construction

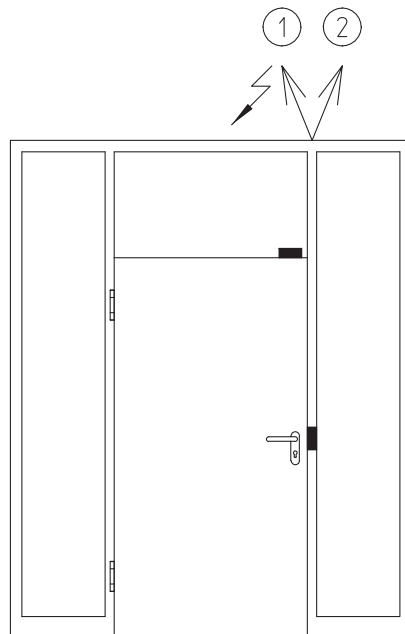

1-leaf door with top panel with side panel or with an unseparated solid wood construction

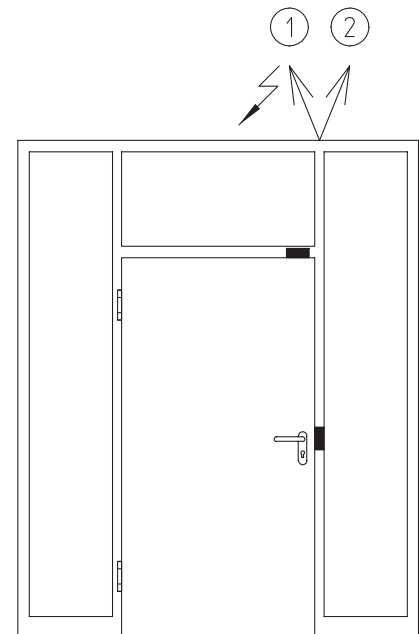

1-leaf door with transom with side panel or with an unseparated solid wood construction

Wooden special doors

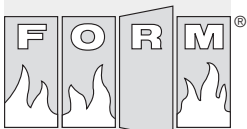

Attention: All measurements refer to frame rebate dimensions respectively reference rebates for top panel and transom.

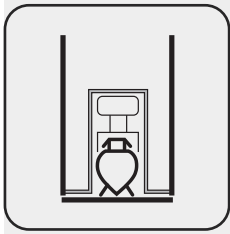

Requirement-accordant equipment

Power supplies

2.2 Electrical strikes, 2-leaf door

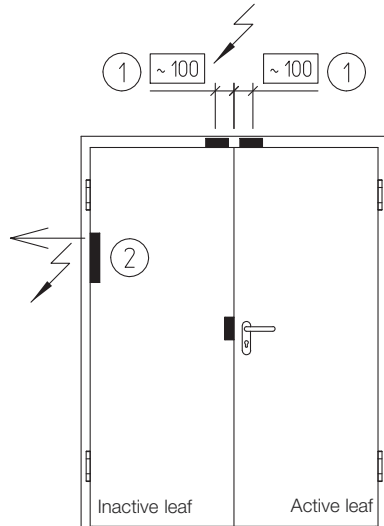

- ① Electrical strike on the upper bolting device (for locks with upper bolting device)
- ② Electrical strike on the main lock



2-leaf door, lintel-high

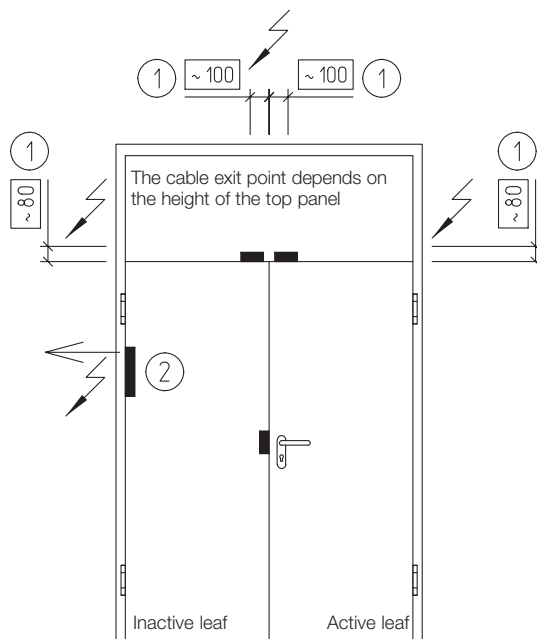

2-leaf door with top panel

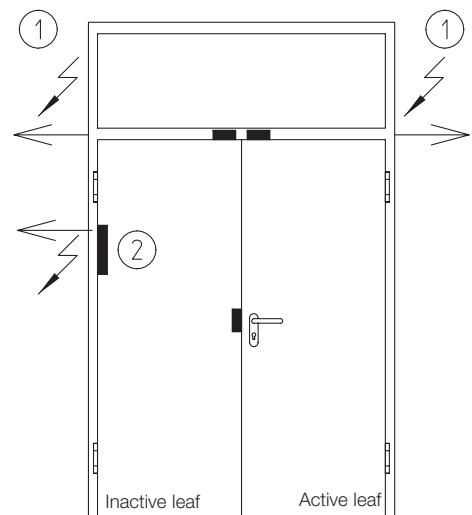

2-leaf door with transom

Wooden special doors



Attention: All measurements refer to frame rebate dimensions respectively reference rebates for top panel and transom.

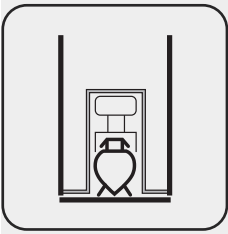

Special equipment

15.12

Requirement-accordant equipment

Power supplies

2.3 Electrical strikes, 2-leaf door with side panel

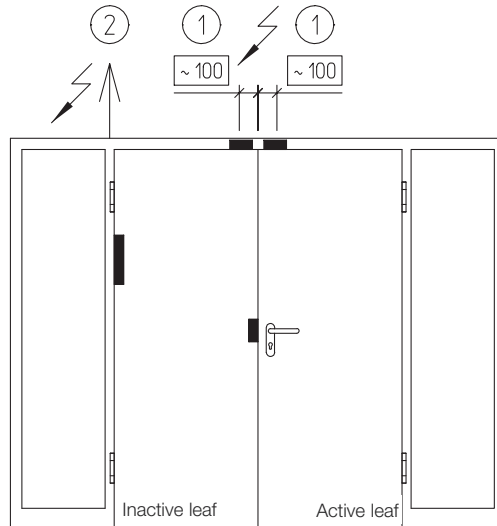

- ① Electrical strike on the upper bolting device (for locks with upper bolting device)
- ② Electrical strike on the main lock

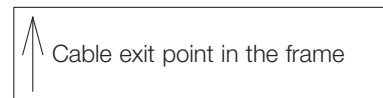

2-leaf door, lintel-high with side panel or with an unseparated solid wood construction

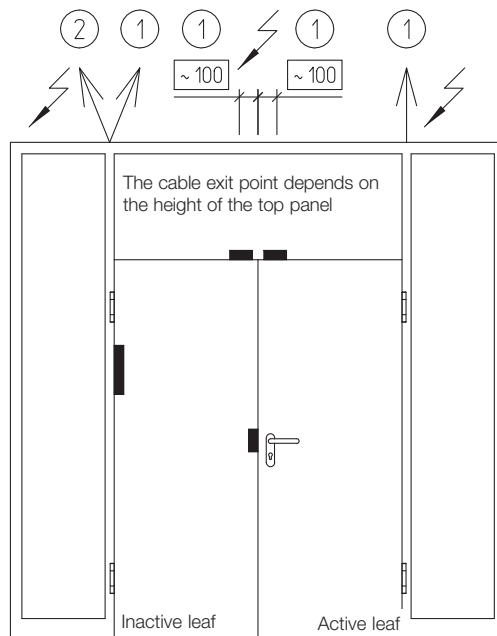

2-leaf door with top panel with side panel or with an unseparated solid wood construction

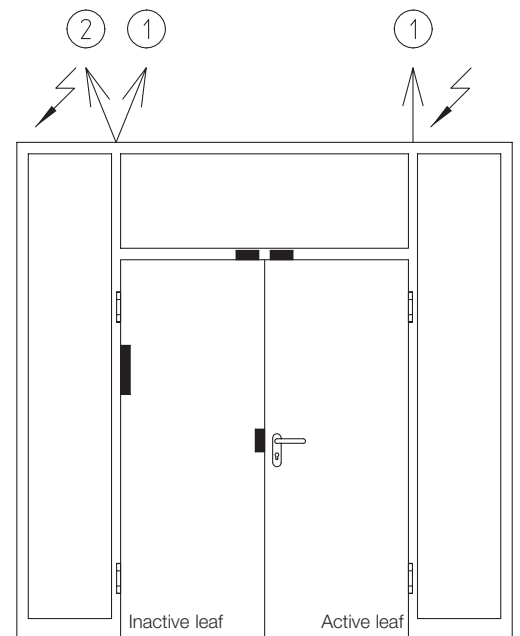

2-leaf door with transom with side panel or with an unseparated solid wood construction

Wooden special doors

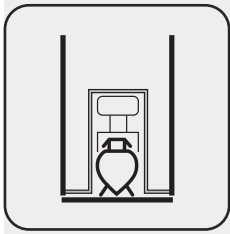

Special equipment

15.12

Requirement-accordant equipment

Power supplies

3. Gleitschienenschließer, bandseitige Normalmontage

3.1 DORMA TS 93 Contur (1-leaf door)

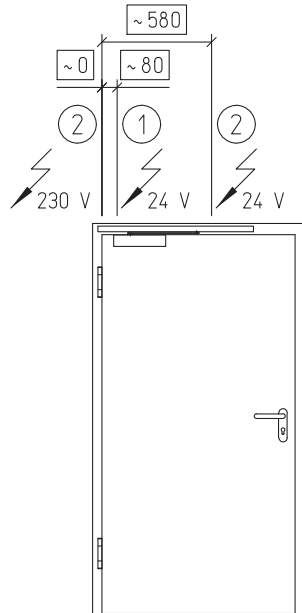

1-leaf door, lintel-high

- ① DORMA TS 93 EMF Contur
- ② DORMA TS 93 EMR Contur

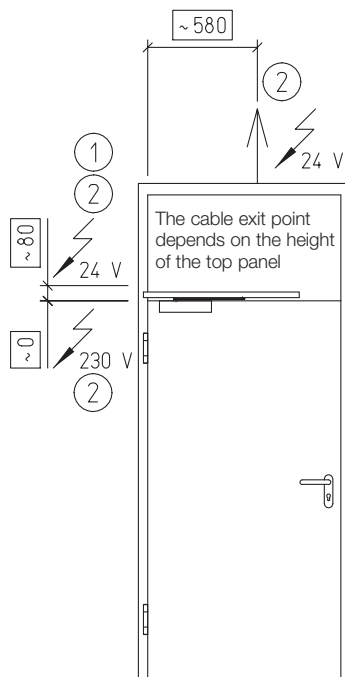
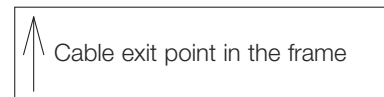

1-leaf door with top panel

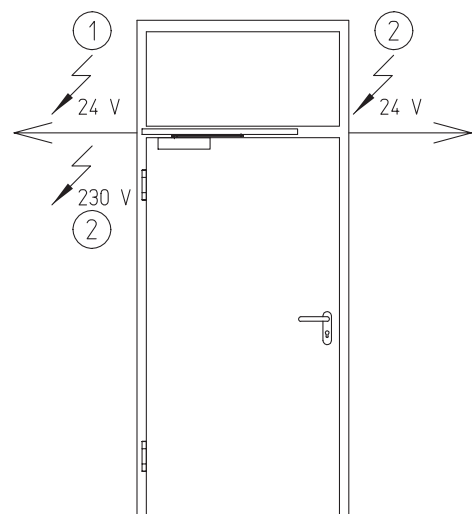

1-leaf door with transom

Wooden special doors

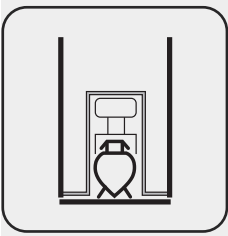

Requirement-accordant equipment

Power supplies

3.2 DORMA TS 93 Contur (1-leaf door with side panel)

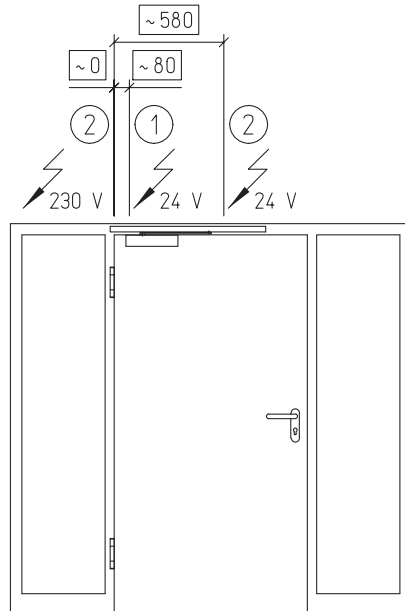

① DORMA TS 93 EMF Contur

② DORMA TS 93 EMR Contur



1-leaf door, lintel-high with side panel or with an unseparated solid wood construction

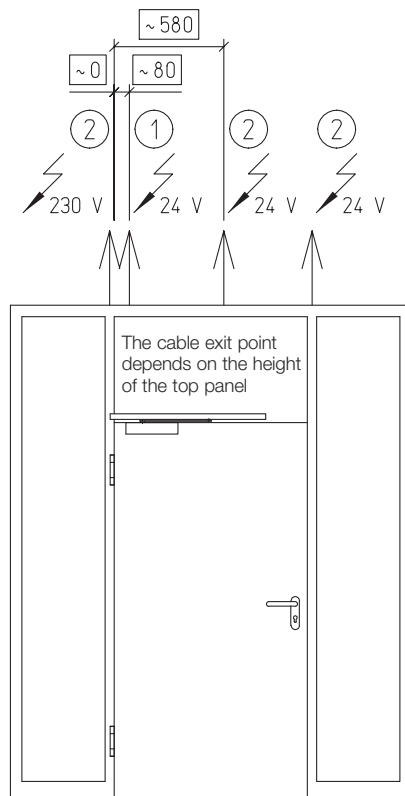

1-leaf door with top panel with side panel or with an unseparated solid wood construction

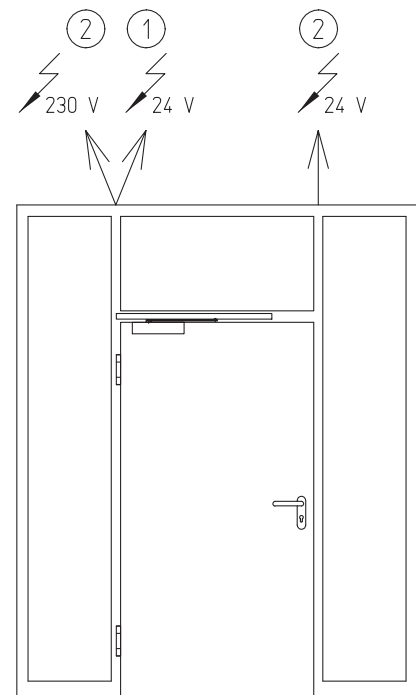

1-leaf door with transom with side panel or with an unseparated solid wood construction

Attention: All measurements refer to frame rebate dimensions respectively reference rebates for top panel and transom.

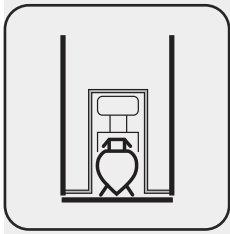

Special equipment

15.12

Requirement-accordant equipment

Power supplies

3.3 DORMA TS 93 GSR-EMF / -EMR Contur (2-leaf door)

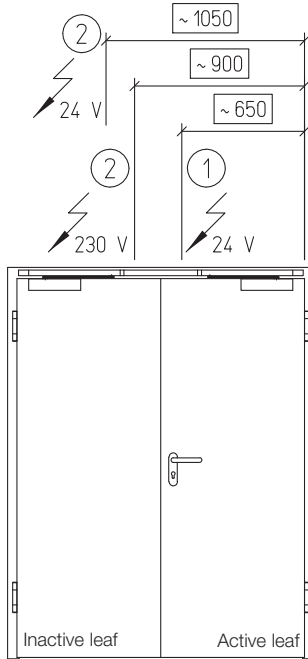

2-leaf door, lintel-high

- ① DORMA TS 93 GSR-EMF Contur
- ② DORMA TS 93 GSR-EMR Contur

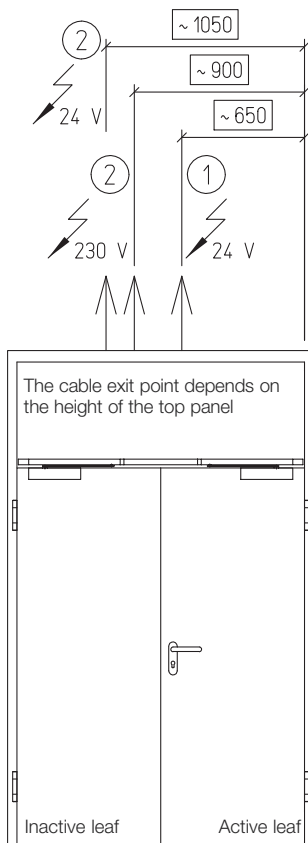
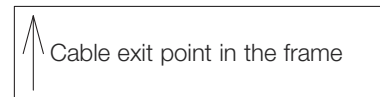

2-leaf door with top panel

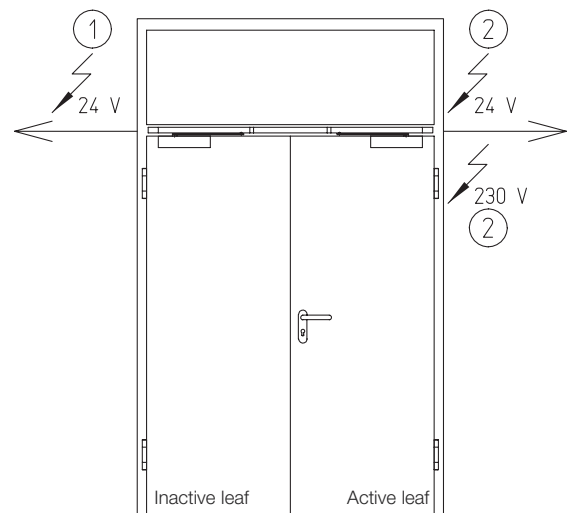

2-leaf door with transom

Attention: All measurements refer to frame rebate dimensions respectively reference rebates for top panel and transom.

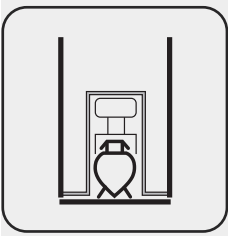

Special equipment

15.12

Requirement-accordant equipment

Power supplies

3.4 DORMA TS 93 GSR-EMF / -EMR Contur (2-leaf door with side panel)

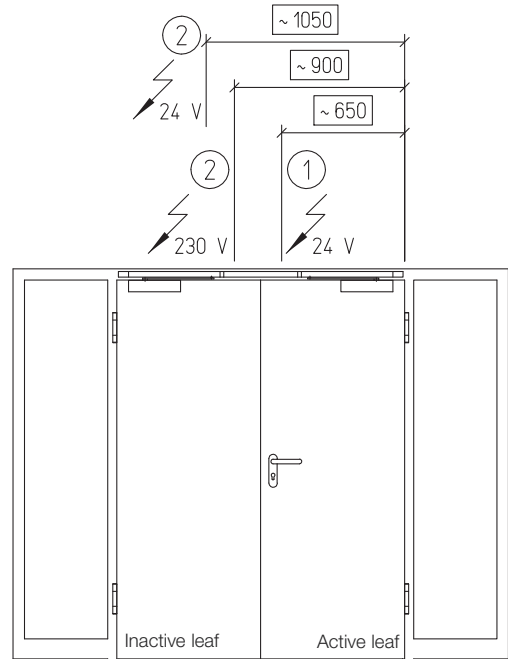

- ① DORMA TS 93 GSR-EMF Contur
- ② DORMA TS 93 GSR-EMR Contur



2-leaf door, lintel-high with side panel or with an unseparated solid wood construction

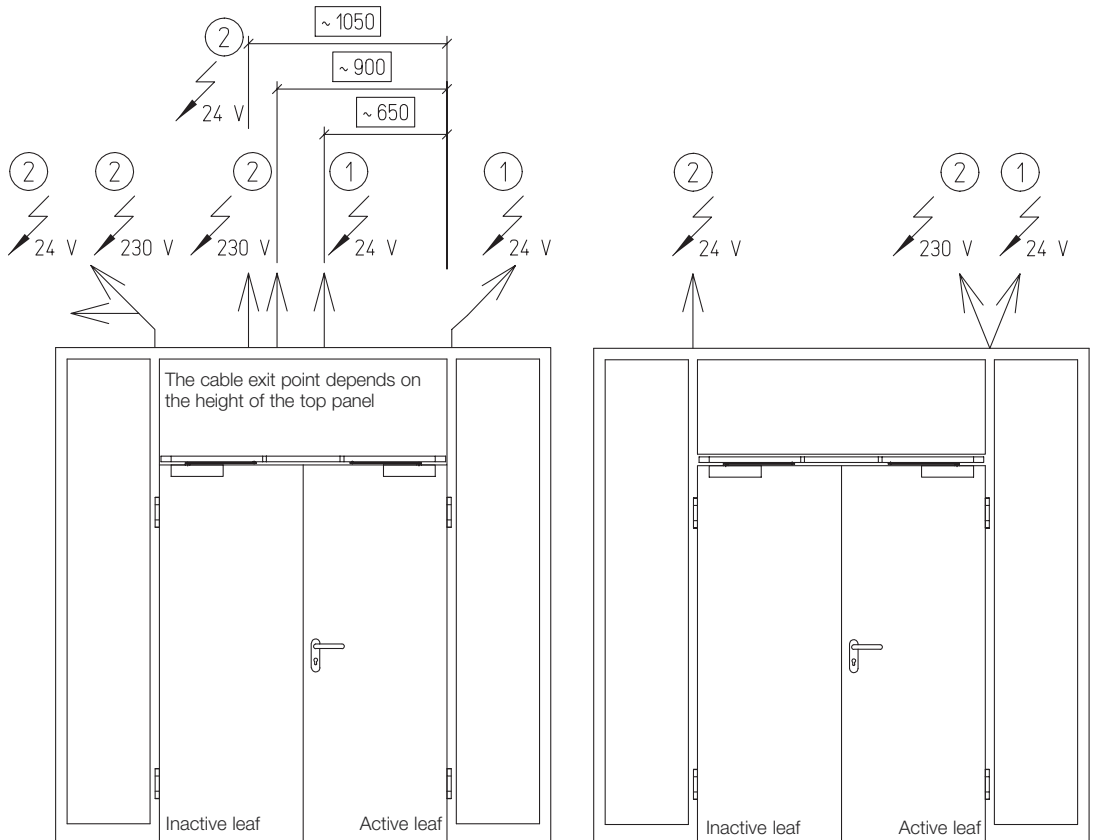

2-leaf door with top panel with side panel or with an unseparated solid wood construction

2-leaf door with transom with side panel or with an unseparated solid wood construction

Wooden special doors



Attention: All measurements refer to frame rebate dimensions respectively reference rebates for top panel and transom.

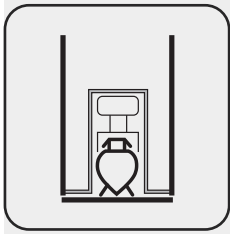

Special equipment

15.12

Requirement-accordant equipment

Power supplies

3.5 GEZE TS 5000 E (1-leaf door)

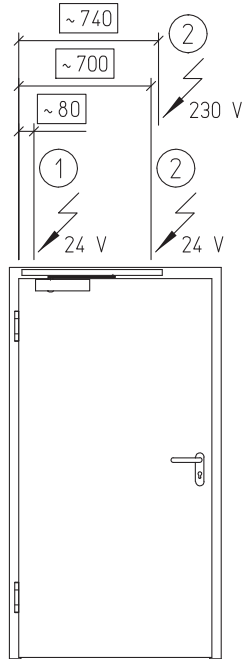

1-leaf door, lintel-high

① GEZE TS 5000 E

② GEZE TS 5000 R

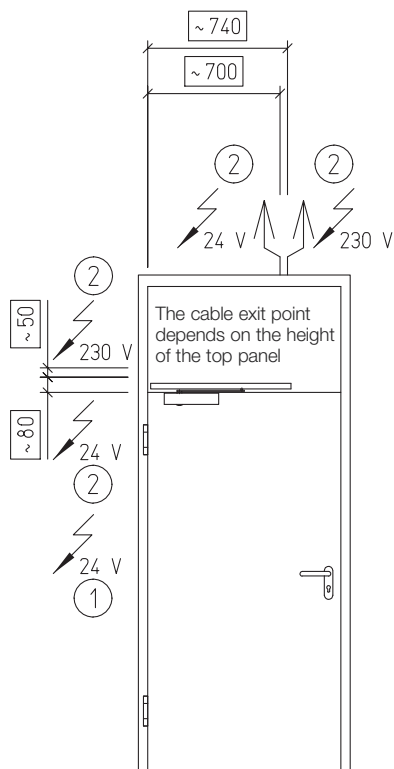

1-leaf door with top panel

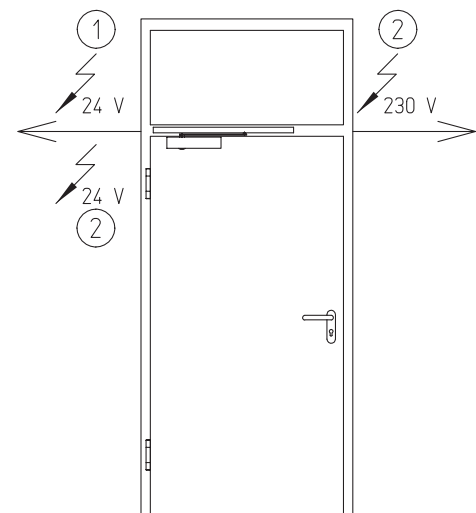

1-leaf door with transom

Attention: All measurements refer to frame rebate dimensions respectively reference rebates for top panel and transom.

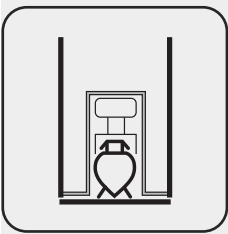

Special equipment

15.12

Requirement-accordant equipment

Power supplies

3.6 GEZE TS 5000 E (1-leaf door with side panel)

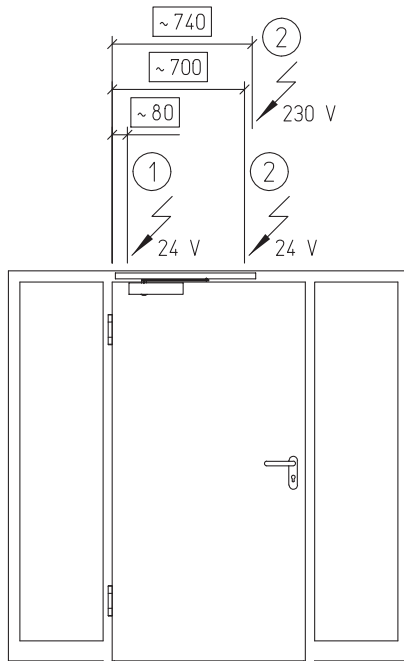

① GEZE TS 5000 E

② GEZE TS 5000 R

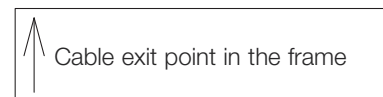

1-leaf door, lintel-high with side panel or with an unseparated solid wood construction

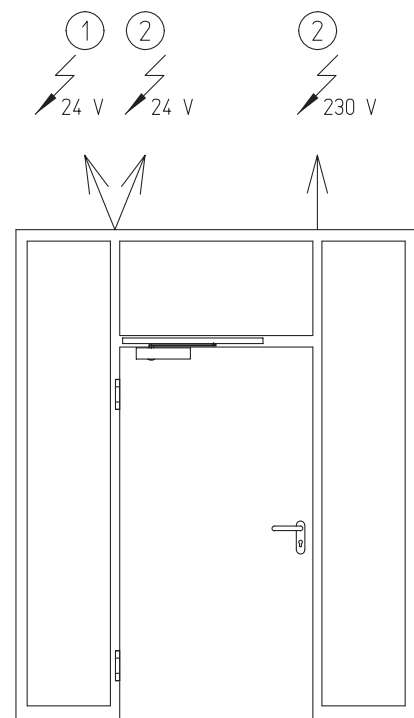
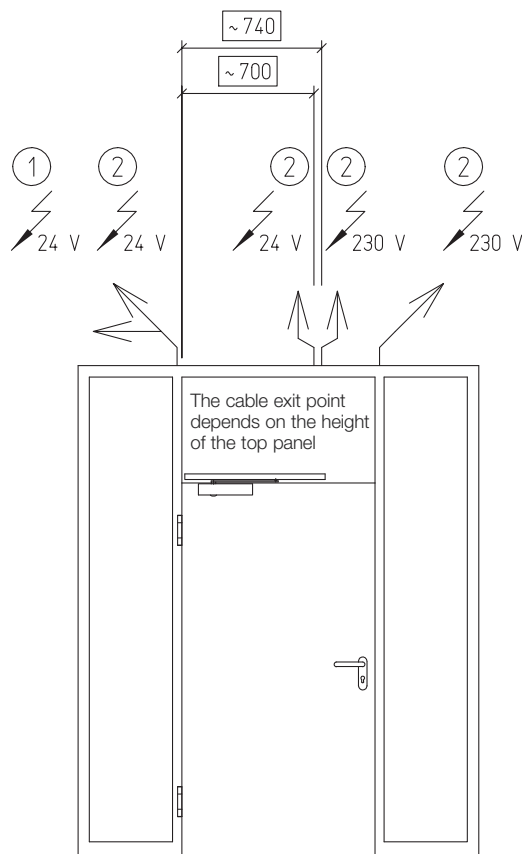

1-leaf door with top panel with side panel or with an unseparated solid wood construction

1-leaf door with transom with side panel or with an unseparated solid wood construction

Attention: All measurements refer to frame rebate dimensions respectively reference rebates for top panel and transom.

Wooden special doors

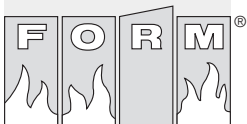

Schörhuber

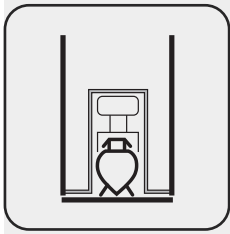

Special equipment

15.12

Requirement-accordant equipment

Power supplies

3.7 GEZE TS 5000 E-IS (2-leaf door)

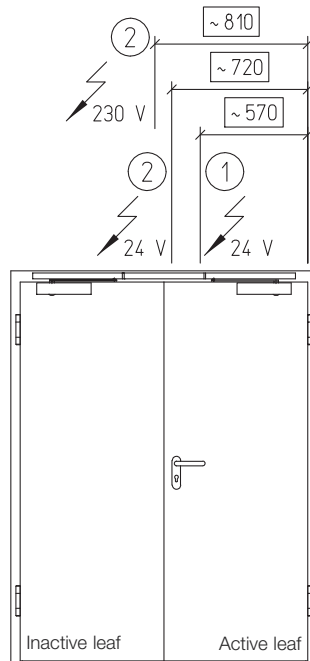

2-leaf door, lintel-high

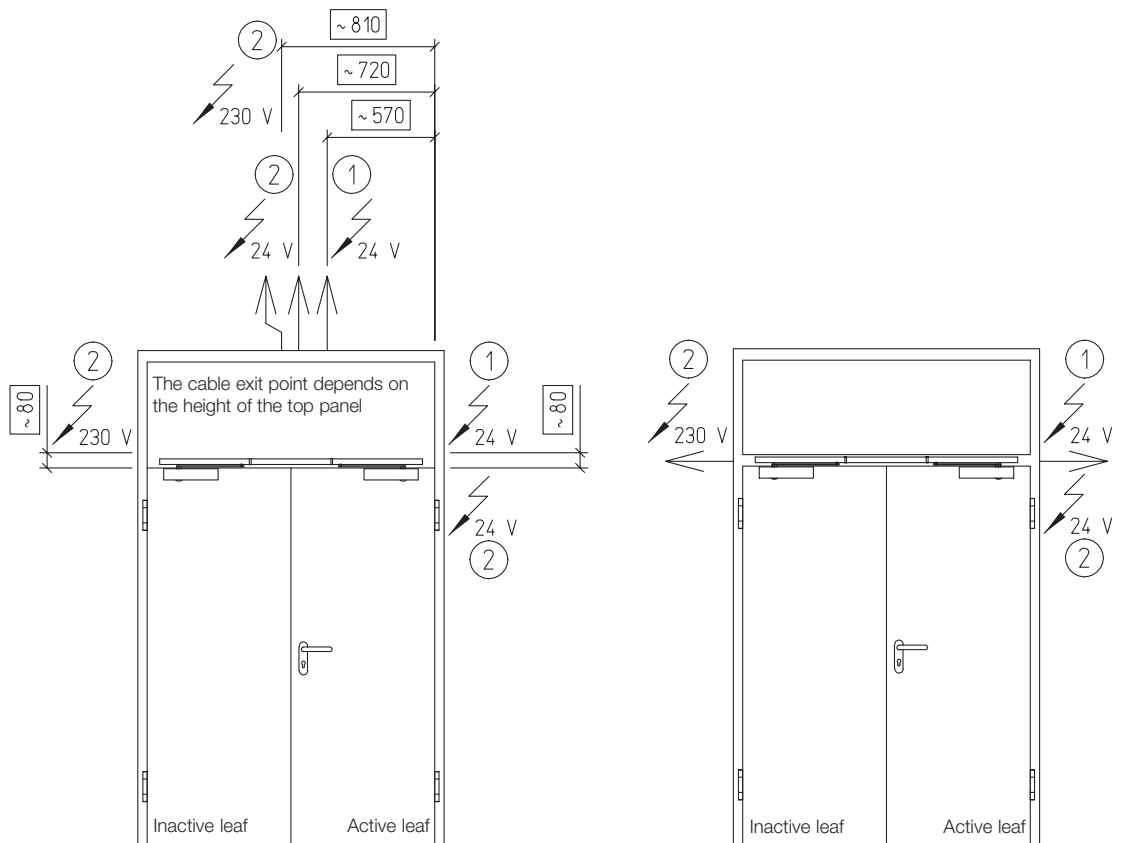

2-leaf door with top panel

2-leaf door with transom

Attention: All measurements refer to frame rebate dimensions respectively reference rebates for top panel and transom.

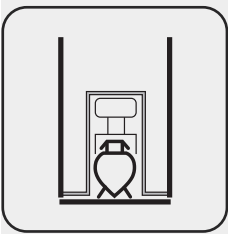

Special equipment

15.12

Requirement-accordant equipment

Power supplies

3.8 GEZE TS 5000 E -IS (2-leaf door with side panel)

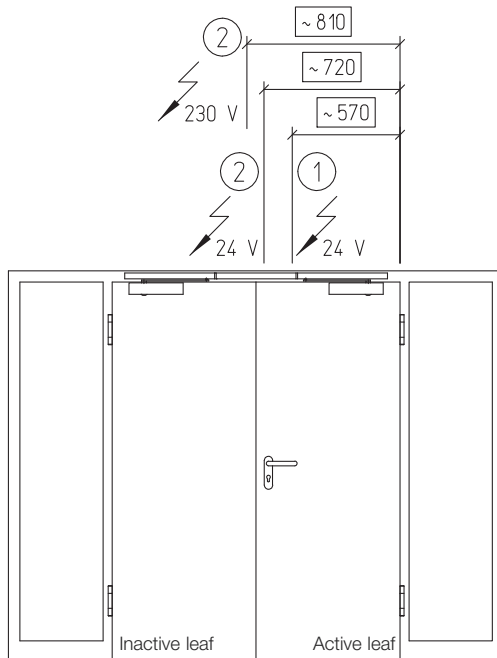

① GEZE TS 5000 E - IS

② GEZE TS 5000 R - IS

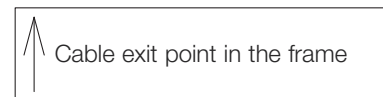

2-leaf door, lintel-high with side panel or with an unseparated solid wood construction

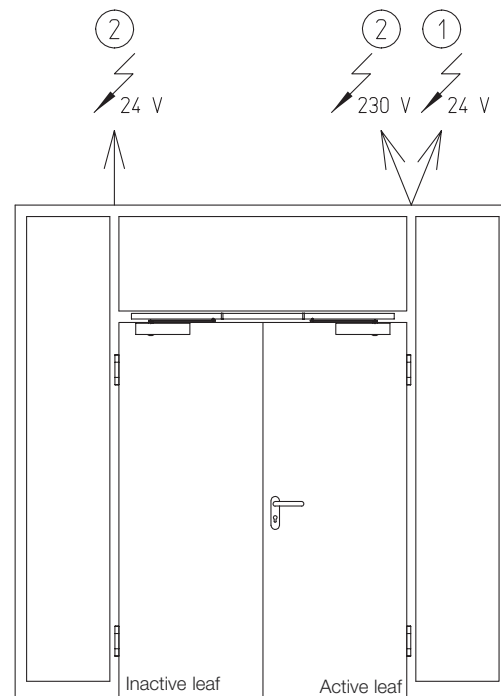
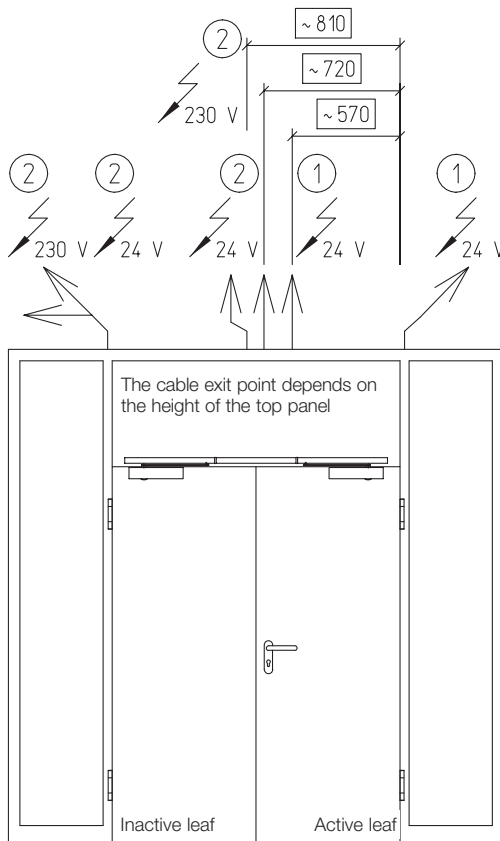

2-leaf door with top panel with side panel or with an unseparated solid wood construction

2-leaf door with transom with side panel or with an unseparated solid wood construction

Attention: All measurements refer to frame rebate dimensions respectively reference rebates for top panel and transom.

Wooden special doors

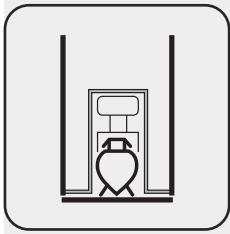

Requirement-accordant equipment

Power supplies

4. Integrated door closer with hold-open device

4.1 DORMA ITS 96 EMF (1-leaf door)

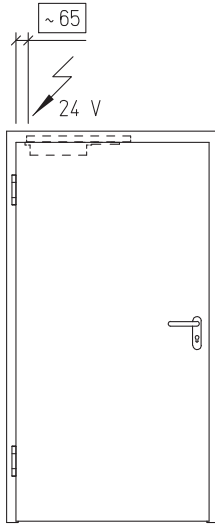

1-leaf door, lintel-high

DORMA ITS 96 EMF

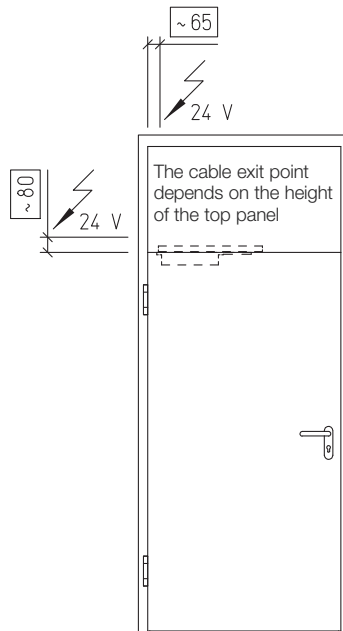
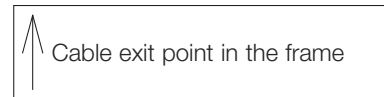

1-leaf door with top panel

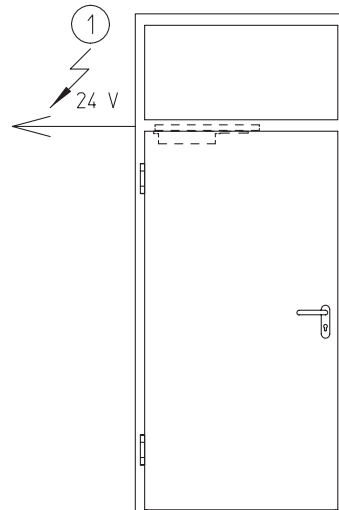

1-leaf door with transom

Wooden special doors

Attention: All measurements refer to frame rebate dimensions respectively reference rebates for top panel and transom.

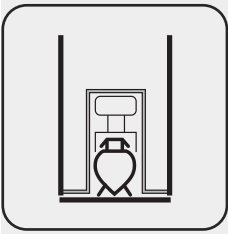

Special equipment

15.12

Requirement-accordant equipment

Power supplies

4.2 DORMA ITS 96 EMF (1-leaf door with side panel)

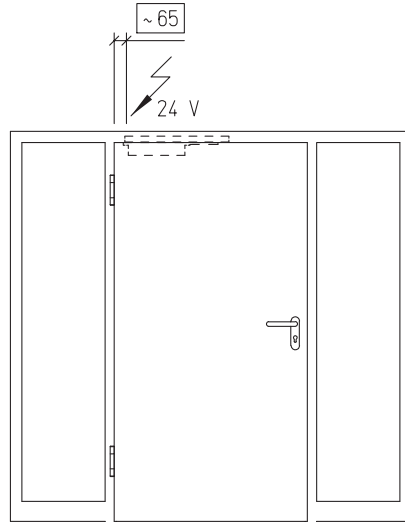

DORMA ITS 96 EMF



1-leaf door, lintel-high with side panel or with an unseparated solid wood construction

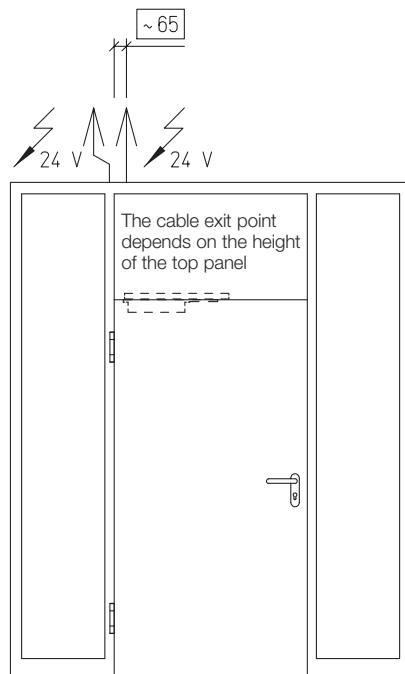

1-leaf door with top panel with side panel or with an unseparated solid wood construction

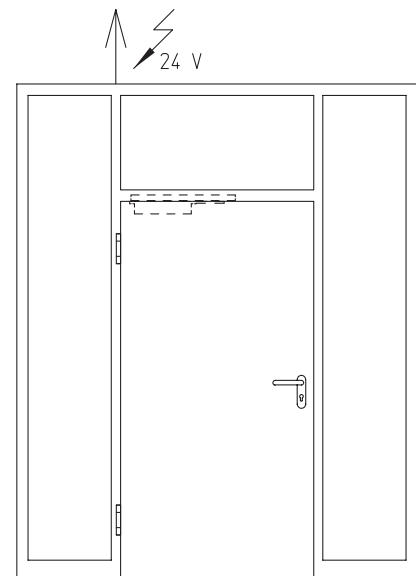

1-leaf door with transom with side panel or with an unseparated solid wood construction

Wooden special doors

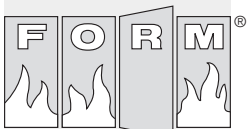

Schörghuber

Attention: All measurements refer to frame rebate dimensions respectively reference rebates for top panel and transom.

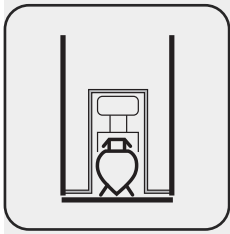

Special equipment

15.12

Requirement-accordant equipment

Power supplies

4.3 DORMA ITS 96 GSR-EMF (2-leaf door)

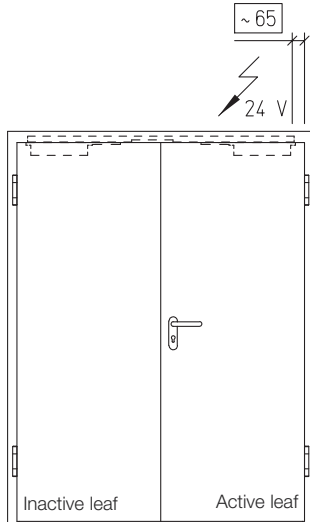

2-leaf door, lintel-high

DORMA ITS 96 GSR-EMF

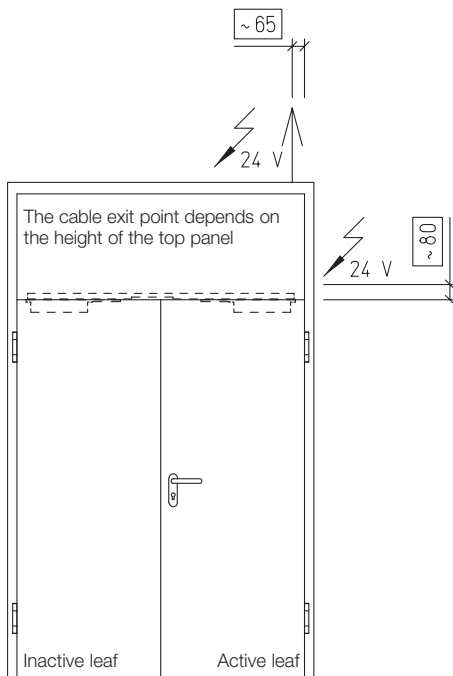

2-leaf door with top panel

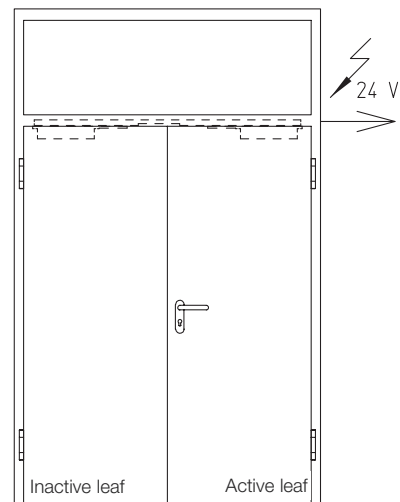

2-leaf door with transom

Wooden special doors



Attention: All measurements refer to frame rebate dimensions respectively reference rebates for top panel and transom.

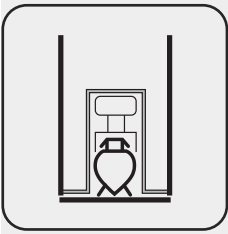

Special equipment

15.12

Requirement-accordant equipment

Power supplies

4.4 DORMA ITS 96 GSR-EMF (2-leaf door with side panel)

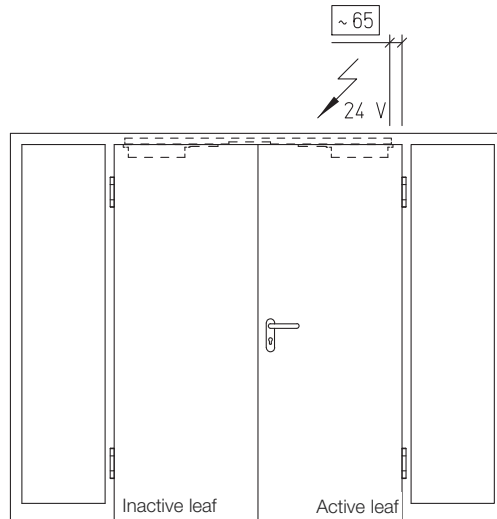

DORMA ITS 96 GSR-EMF

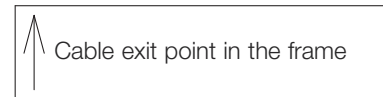

2-leaf door, lintel-high with side panel or with an unseparated solid wood construction

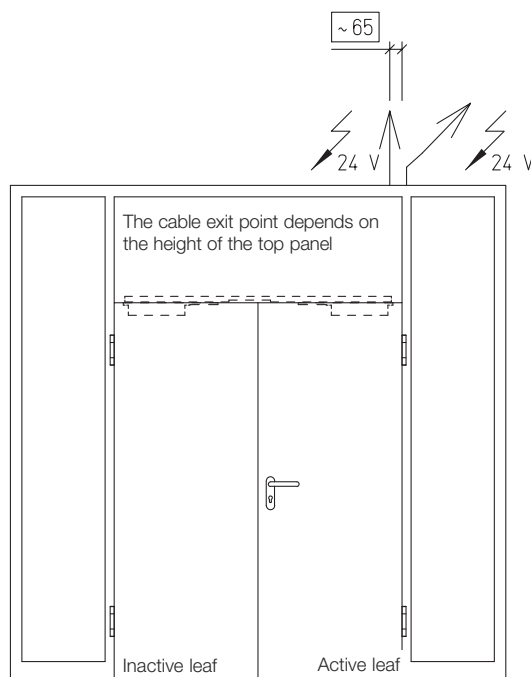

2-leaf door with top panel with side panel or with an unseparated solid wood construction

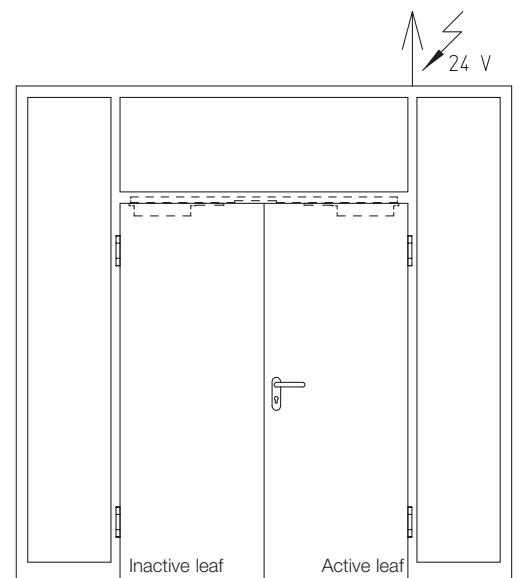

2-leaf door with transom with side panel or with an unseparated solid wood construction

Wooden special doors

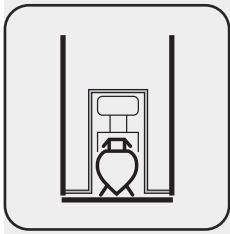

Special equipment

15.12

Requirement-accordant equipment

Power supplies

4.5 GEZE Boxer E (1-leaf door)

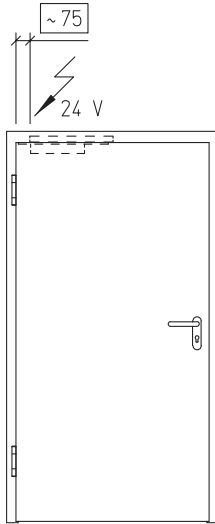

1-leaf door, lintel-high

GEZE BOXER E

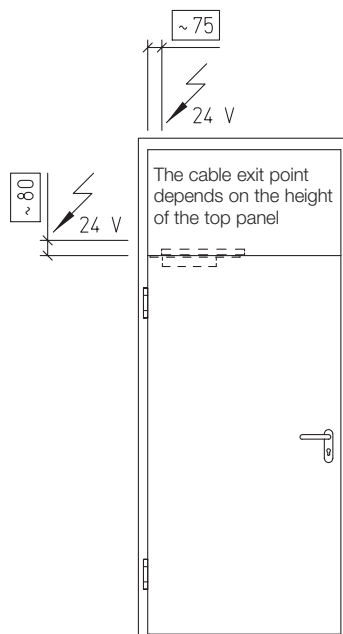
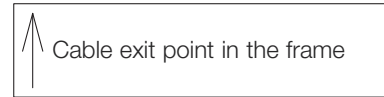

1-leaf door with top panel

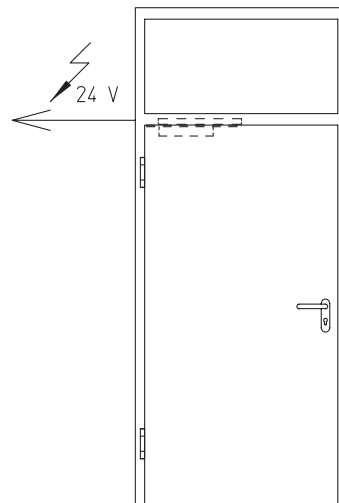

1-leaf door with transom

Wooden special doors



Attention: All measurements refer to frame rebate dimensions respectively reference rebates for top panel and transom.

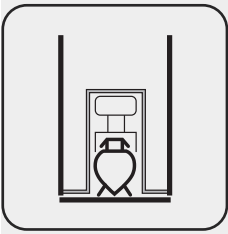

Special equipment

15.12

Requirement-accordant equipment

Power supplies

4.6 GEZE Boxer E (1-leaf door with side panel)

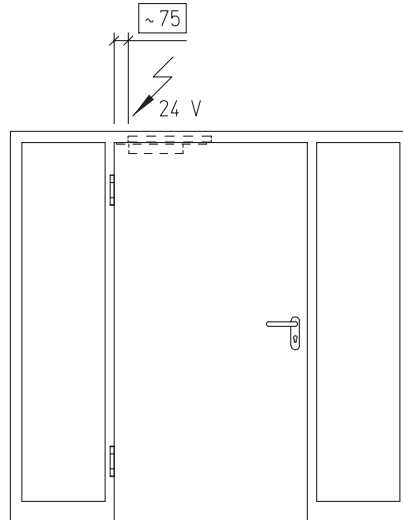

GEZE BOXER E



1-leaf door, lintel-high with side panel or with an unseparated solid wood construction

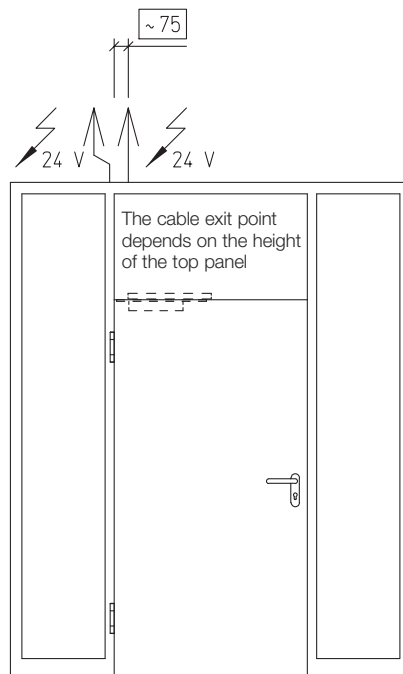

1-leaf door with top panel with side panel or with an unseparated solid wood construction

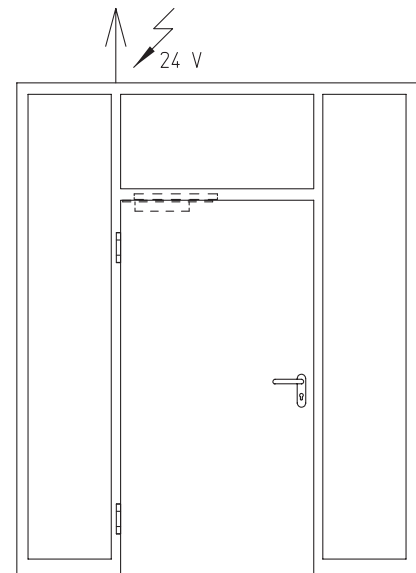

1-leaf door with transom with side panel or with an unseparated solid wood construction

Wooden special doors

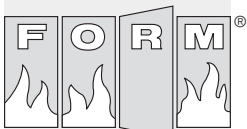

Schörghuber

Attention: All measurements refer to frame rebate dimensions respectively reference rebates for top panel and transom.

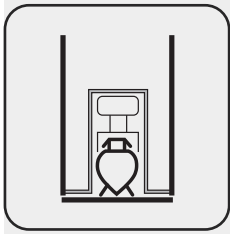

Special equipment

15.12

Requirement-accordant equipment

Power supplies

4.7 GEZE Boxer ISM-E (2-leaf door)

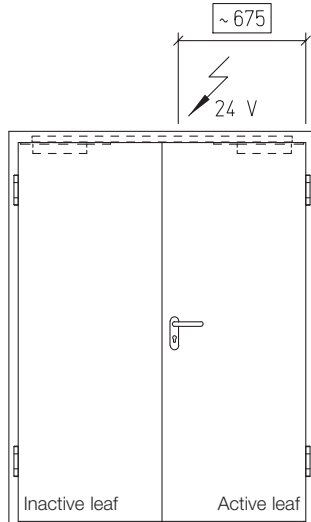

2-leaf door, lintel-high

GEZE BOXER ISM-E

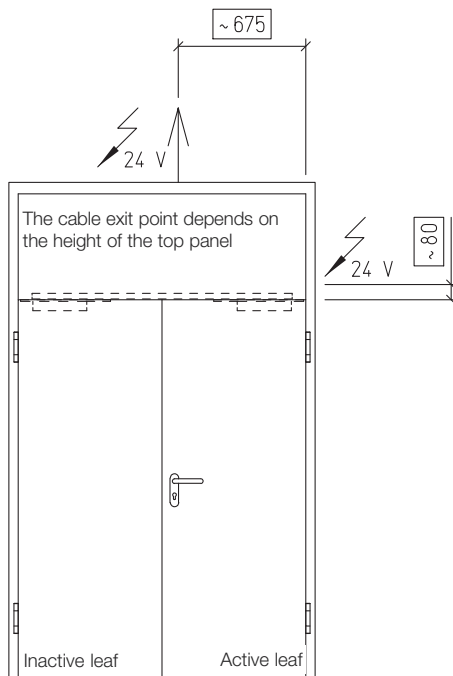

2-leaf door with top panel

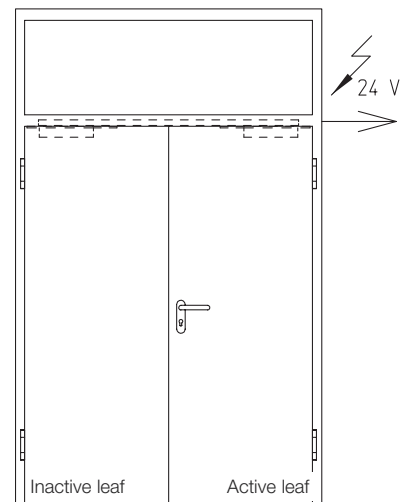

2-leaf door with transom

Wooden special doors



Attention: All measurements refer to frame rebate dimensions respectively reference rebates for top panel and transom.

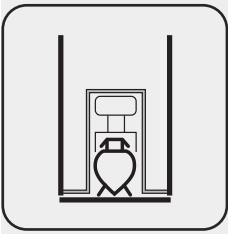

Special equipment

15.12

Requirement-accordant equipment

Power supplies

4.8 GEZE Boxer ISM-E (2-leaf door with side panel)

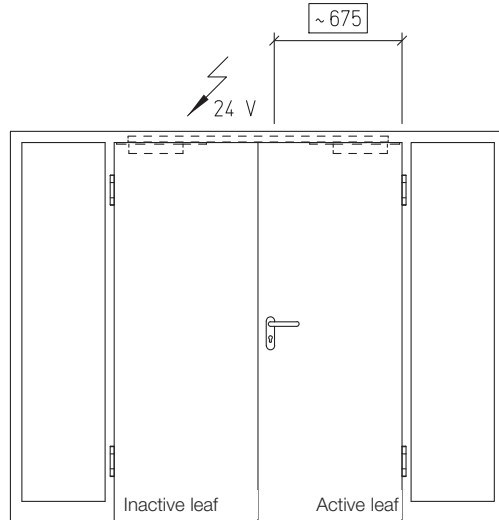

GEZE BOXER ISM-E

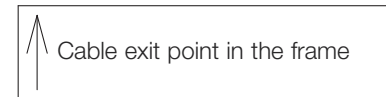

2-leaf door, lintel-high with side panel or with an unseparated solid wood construction

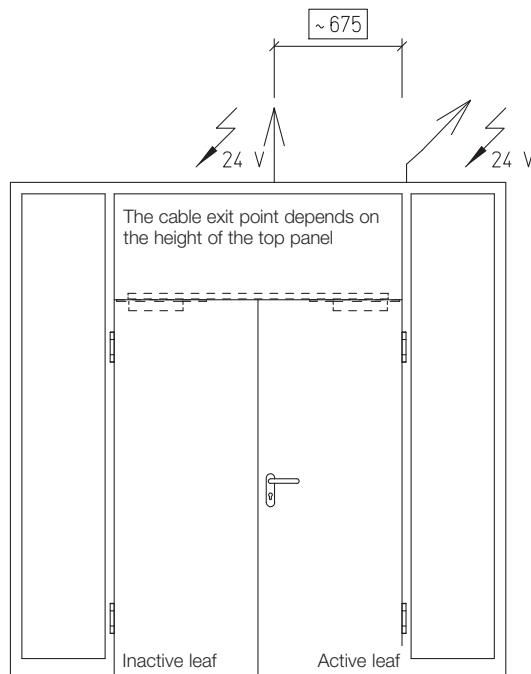

2-leaf door with top panel with side panel or with an unseparated solid wood construction

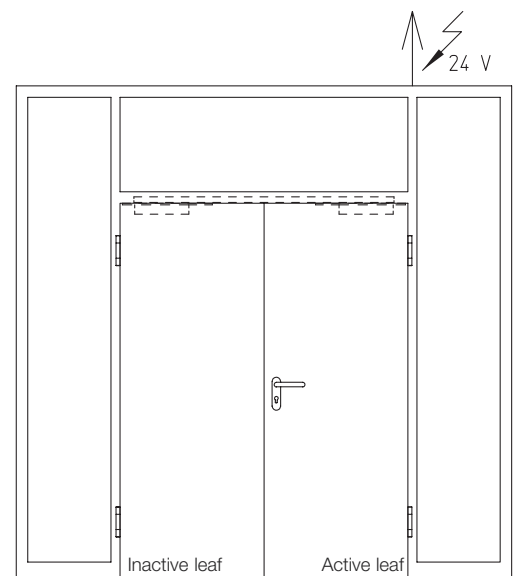

2-leaf door with transom with side panel or with an unseparated solid wood construction

Wooden special doors

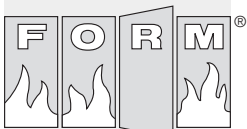

Schörghuber

Attention: All measurements refer to frame rebate dimensions respectively reference rebates for top panel and transom.

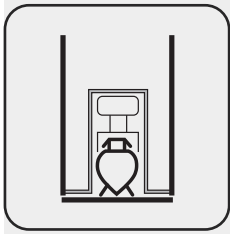

Special equipment

15.12

Requirement-accordant equipment

Power supplies

5. Automatic door operator

5.1 DORMA CD 400 (1-leaf door)

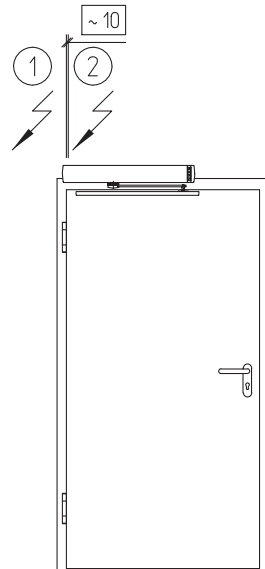

1-leaf door, lintel-high

- ① for 230 V feeder
- ② for sensors, door opener, bolt contact etc.

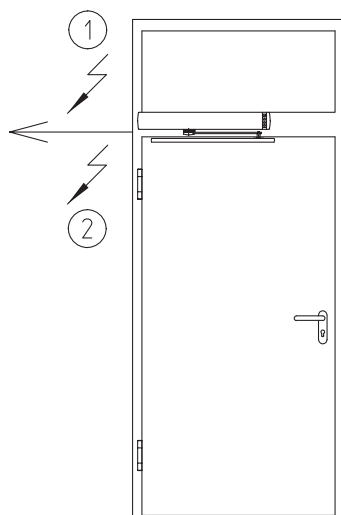

1-leaf door with transom

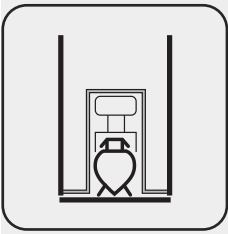

Special equipment

15.12

Requirement-accordant equipment

Power supplies

5.2 DORMA CD 400 (1-leaf door with side panel)

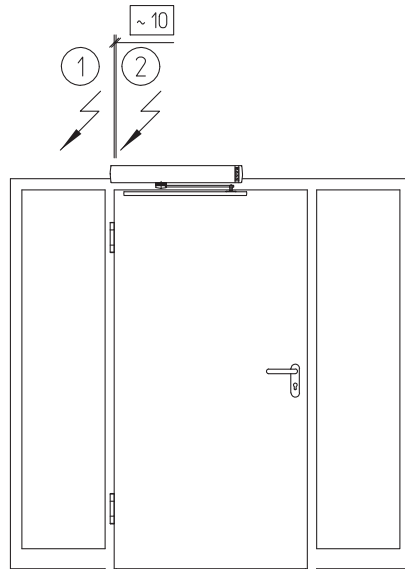

① for 230 V feeder

② for sensors, door opener, bolt contact etc.

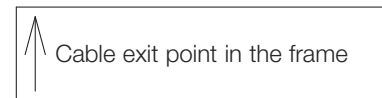

1-leaf door, lintel-high with side panel or with an unseparated solid wood construction

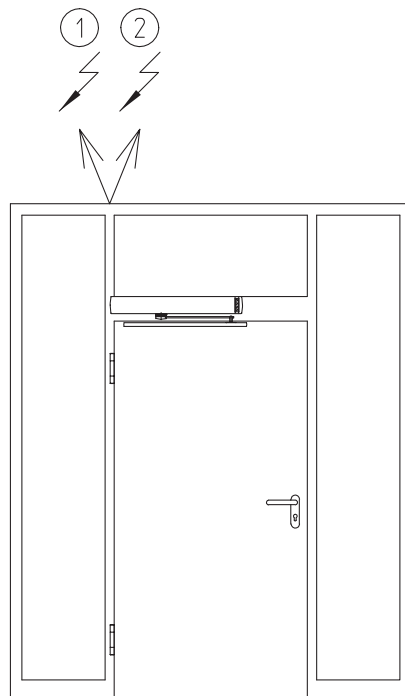

1-leaf door with transom with side panel or with an unseparated solid wood construction

Attention: All measurements refer to frame rebate dimensions respectively reference rebates for top panel and transom.

Wooden special doors

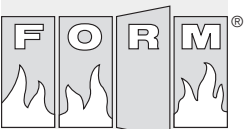

Schörghuber

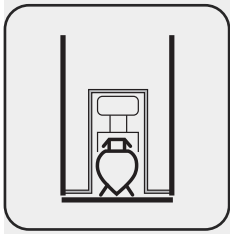

Requirement-accordant equipment

Power supplies

5.3 GEZE EMD-F (1-leaf door)

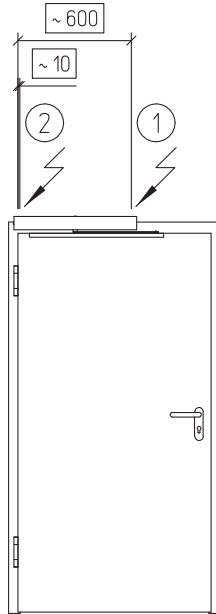

1-leaf door, lintel-high

① for 230 V feeder

② for sensors, door opener, bolt contact etc.

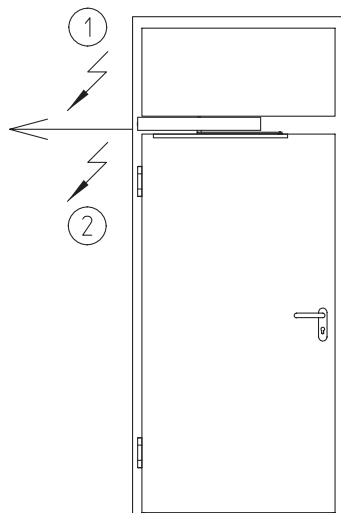
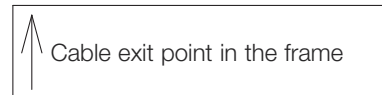

1-leaf door with transom

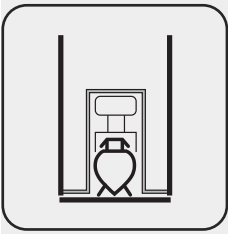

Special equipment

15.12

Requirement-accordant equipment

Power supplies

5.4 GEZE EMD-F (1-leaf door with side panel)

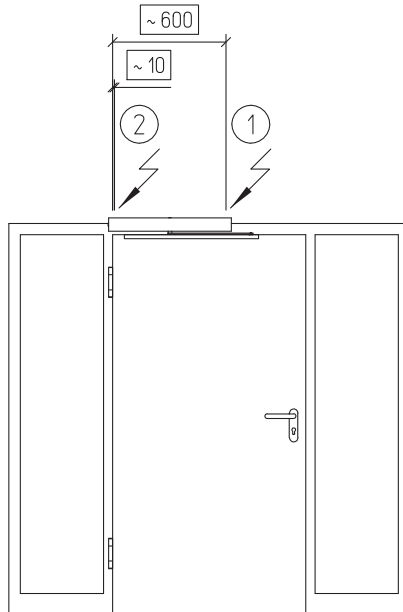

- ① for 230 V feeder
- ② for sensors, door opener, bolt contact etc.

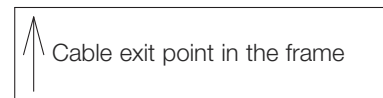

1-leaf door, lintel-high with side panel or with an unseparated solid wood construction

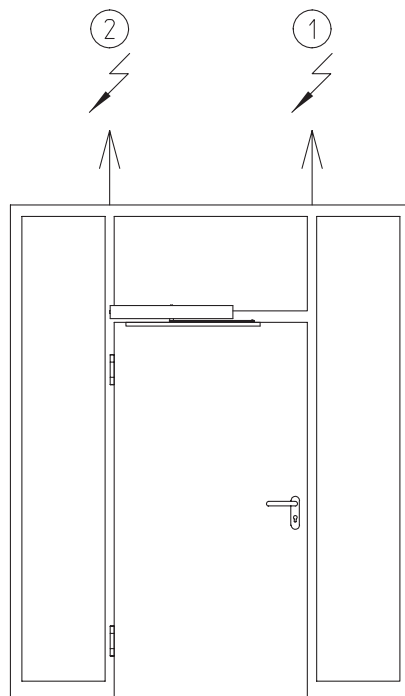

1-leaf door with transom with side panel or with an unseparated solid wood construction

Attention: All measurements refer to frame rebate dimensions respectively reference rebates for top panel and transom.

Wooden special doors

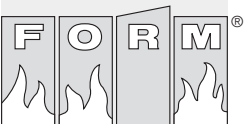

Schörghuber

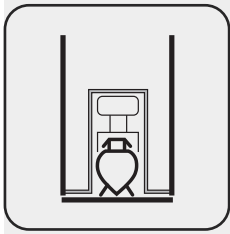

Special equipment

15.12

Requirement-accordant equipment

Power supplies

5.5 DORMA ED 200 (1-leaf door)

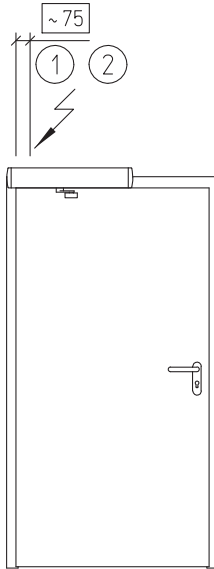

1-leaf door, lintel-high

- ① for 230 V feeder
- ② for sensors, door opener, bolt contact etc.

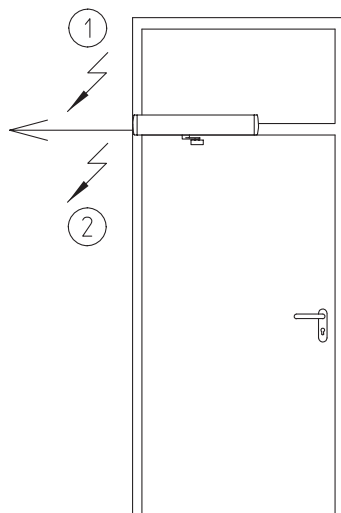
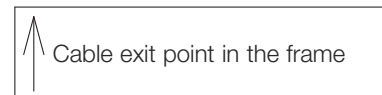

1-leaf door with transom

Wooden special doors

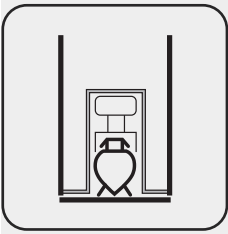

Special equipment

15.12

Requirement-accordant equipment

Power supplies

5.6 DORMA ED 200 (1-leaf door with side panel)

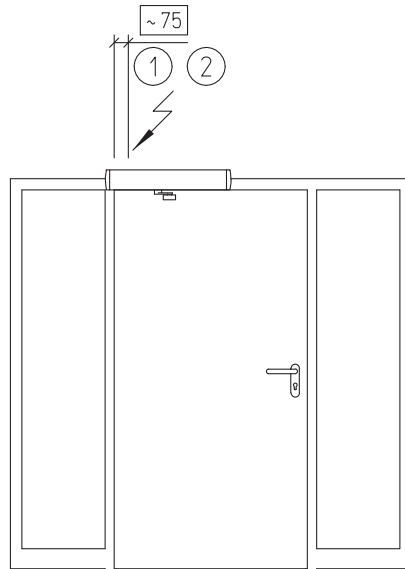

① for 230 V feeder

② for sensors, door opener, bolt contact etc.



1-leaf door, lintel-high with side panel or with an unseparated solid wood construction

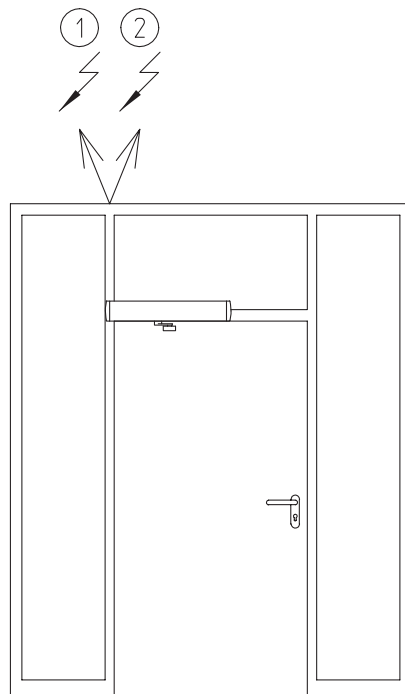

1-leaf door with transom with side panel or with an unseparated solid wood construction

Attention: All measurements refer to frame rebate dimensions respectively reference rebates for top panel and transom.

Wooden special doors

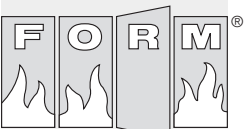

Schörghuber

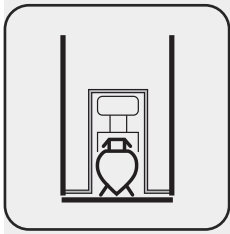

Special equipment

15.12

Requirement-accordant equipment

Power supplies

5.7 DORMA ED 200 ESR (2-leaf door)

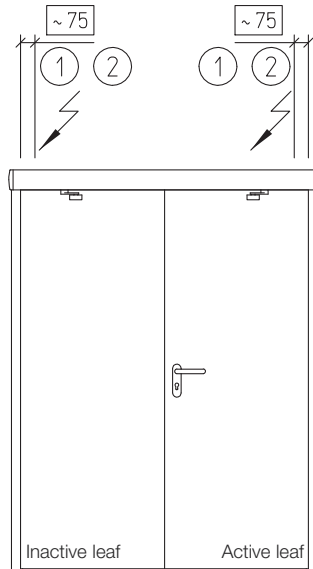

2-leaf door, lintel-high

- ① for 230 V feeder
- ② for sensors, door opener, bolt contact etc.

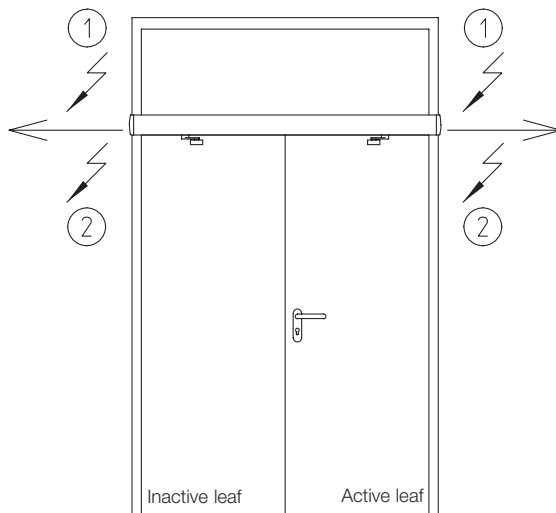
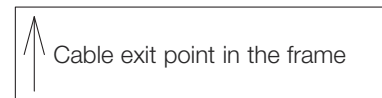

2-leaf door with transom

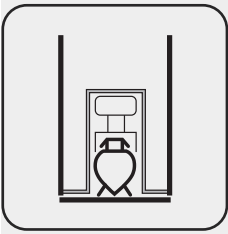

Special equipment

15.12

Requirement-accordant equipment

Power supplies

5.8 DORMA ED 200 ESR (2-leaf door with side panel)

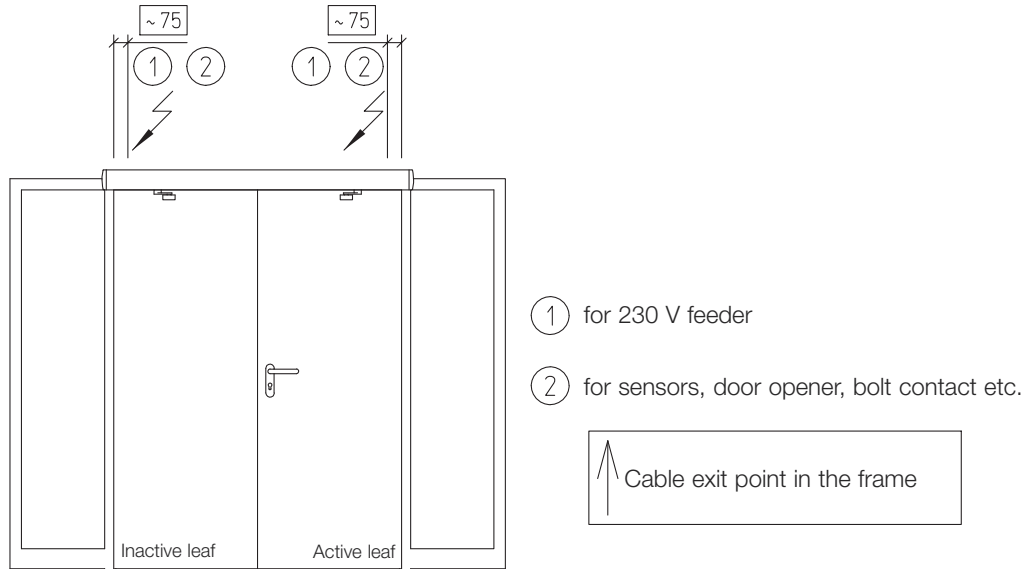

2-leaf door, lintel-high with side panel or with an unseparated solid wood construction

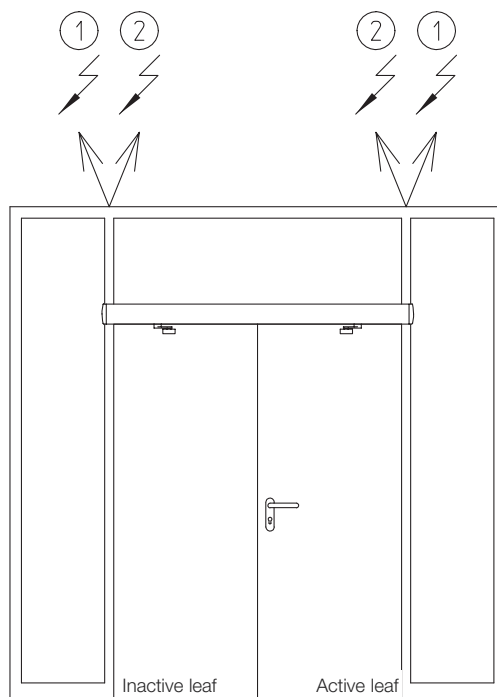

2-leaf door with transom with side panel or with an unseparated solid wood construction

Wooden special doors

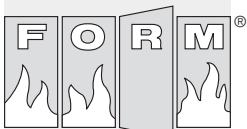

Schörhuber

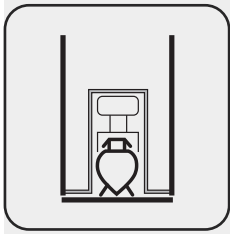

Special equipment

15.12

Requirement-accordant equipment

Power supplies

5.9 GEZE TSA 160 F (1-leaf door)

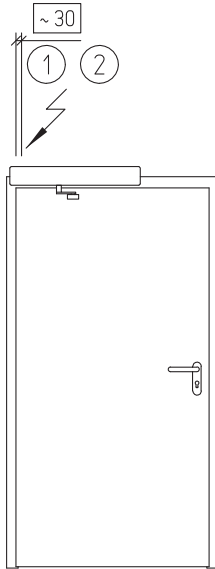

1-leaf door, lintel-high

① for 230 V feeder

② for sensors, door opener, bolt contact etc.

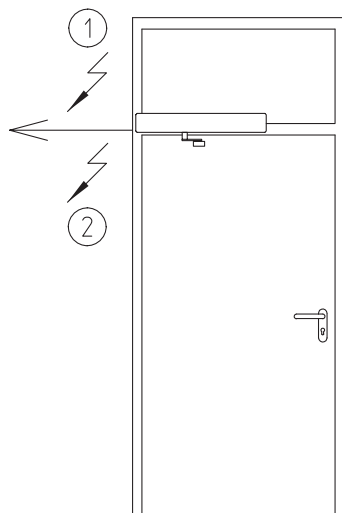
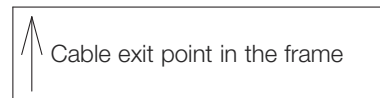

1-leaf door with transom

Wooden special doors

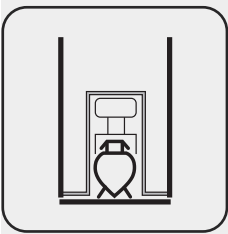

Special equipment

15.12

Requirement-accordant equipment

Power supplies

5.10 GEZE TSA 160 F (1-leaf door with side panel)

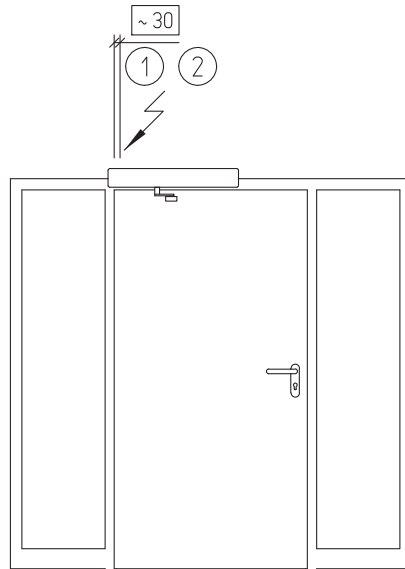

① for 230 V feeder

② for sensors, door opener, bolt contact etc.

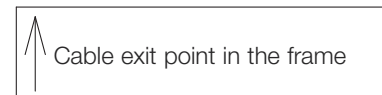

1-leaf door, lintel-high with side panel or with an unseparated solid wood construction

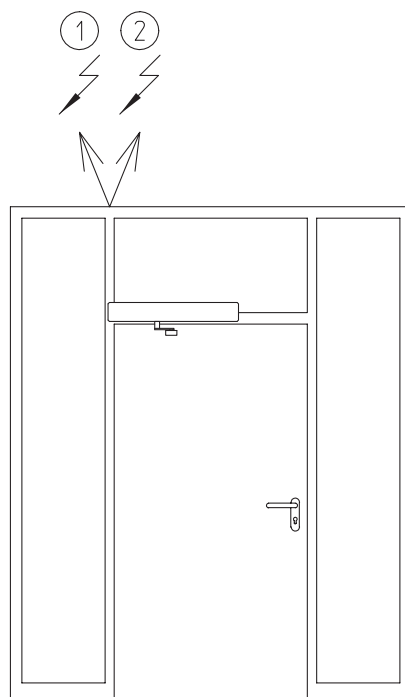

1-leaf door with transom with side panel or with an unseparated solid wood construction

Attention: All measurements refer to frame rebate dimensions respectively reference rebates for top panel and transom.

Wooden special doors

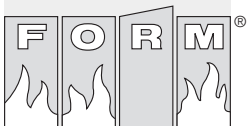

Schörghuber

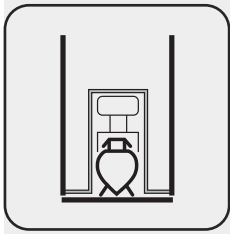

Special equipment

15.12

Requirement-accordant equipment

Power supplies

5.11 GEZE TSA 160 F-IS (2-leaf door)

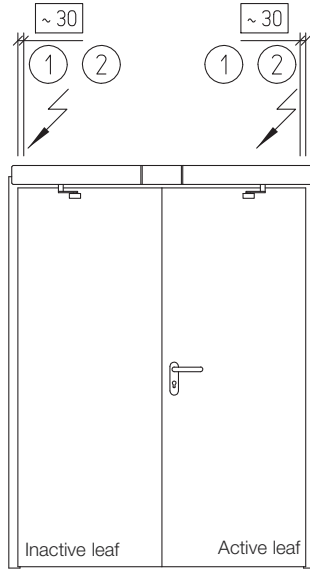

2-leaf door, lintel-high

- ① for 230 V feeder
- ② for sensors, door opener, bolt contact etc.

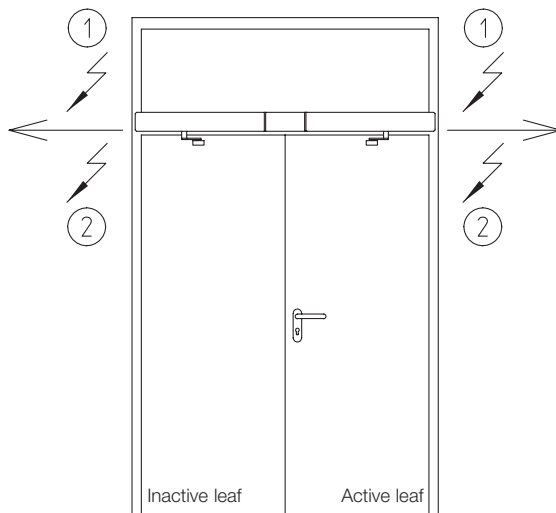
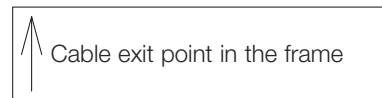

2-leaf door with transom

Wooden special doors

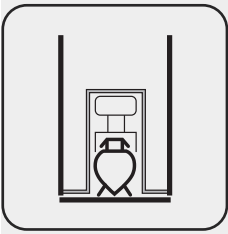

Special equipment

15.12

Requirement-accordant equipment

Power supplies

5.12 GEZE TSA 160 F-IS (2-leaf door with side panel)

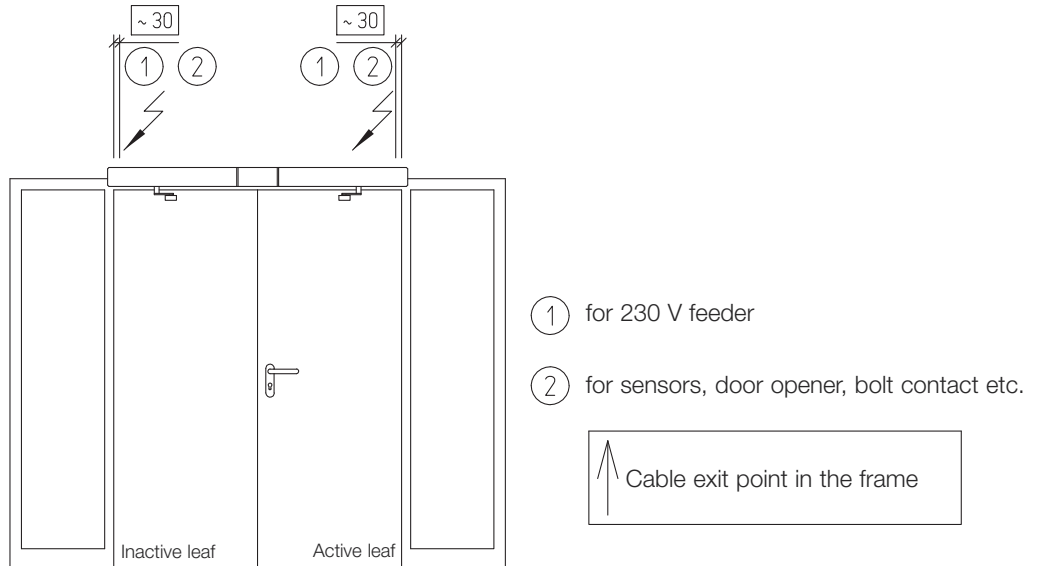

2-leaf door, lintel-high with side panel
 or with an unseparated solid wood construction

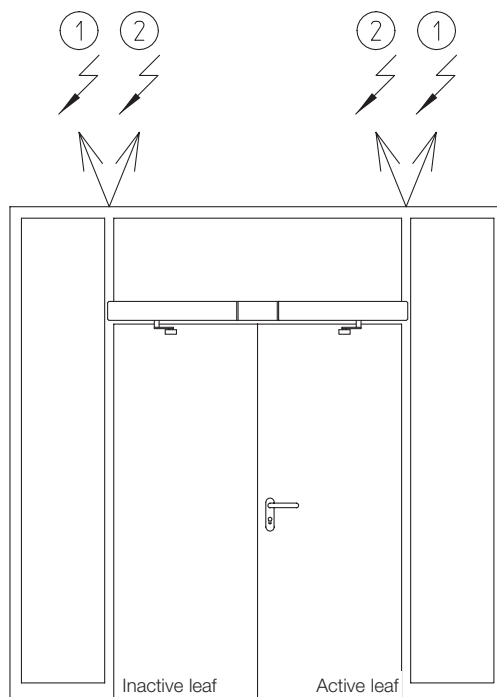

2-leaf door with transom with side panel
 or with an unseparated solid wood construction

Wooden special doors

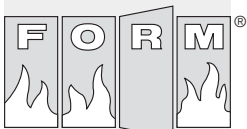

Schörhuber

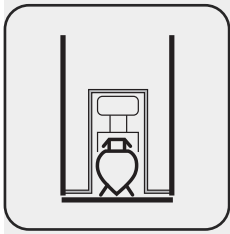

Special equipment

15.13

Requirement-accordant equipment

Kick and push plates

Surface and edge protection

In order to prevent surface or edge damage on the highly used areas of doors, stainless steel or aluminium kick plates are installed.

By default kick plates with a thickness of 1,0 mm are glued to the finished door surface. On request they can be screw fastened in addition .

Alternatively to mounting the kick plates on top of the finished surface, they can also be mounted flush and slotted to the door surface.

According to the DIBt a mounting of strips of metal sheet on the door surface up to a height of and width of about 250 mm is allowed (➔ Chapter 2.3).

Wooden special doors

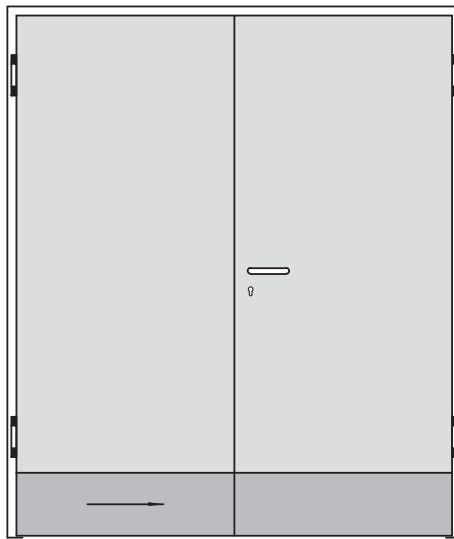

with kick plate

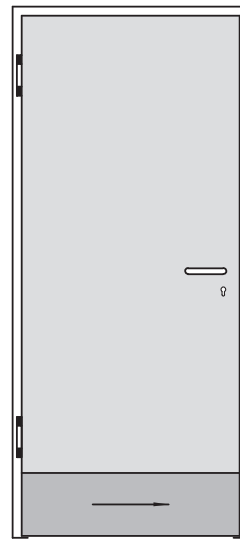

with kick plate

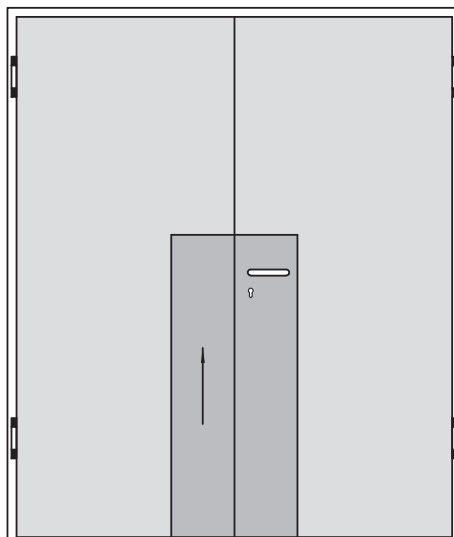

with push plate

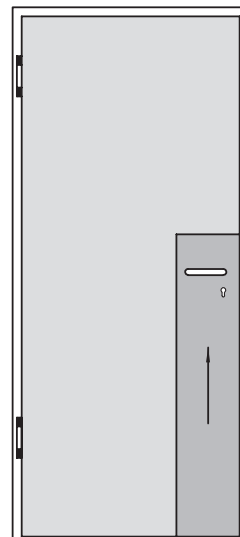

with push plate

→
Grinding direction

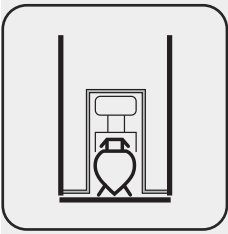

Special equipment

15.14

Requirement-accordant equipment

Ventilation grille and mail slot

Ventilation grille

For the ventilation of closed rooms without a ventilation possibility, as for example Damp Rooms and kitchen etc., ventilation grilles can be inserted in doors. The dimension of the grille as well as the open cross section are subject to the necessary air change rate of the room.

The installation of a ventilation grille is usually just done in Wet Room and Solid Core Doors.

The installation in Fire- and Smoke-Protection-Doors is not permitted.

The position and size of a ventilation grille is suggested in DIN 68706. Differing configurations are possible as long as a minimum frize width is kept.

Mail slot

Apartment doors can be equipped with an additional mail slot. The installation height is according to DIN 68706 by default about 850 mm from the bottom leaf of the door leaf to the mail slot. Mail slots can on request only be installed in Solid Core Doors.

Wooden special doors

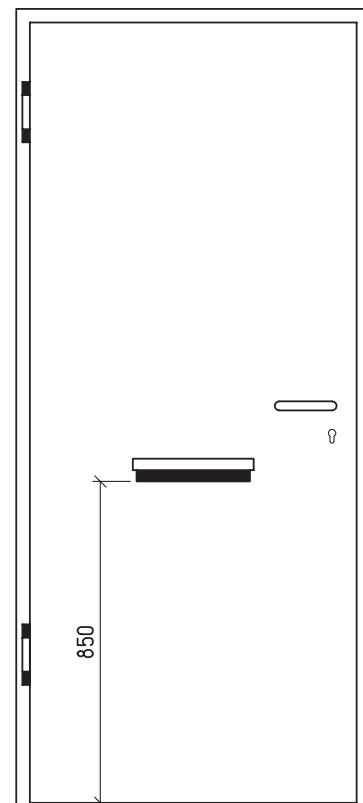
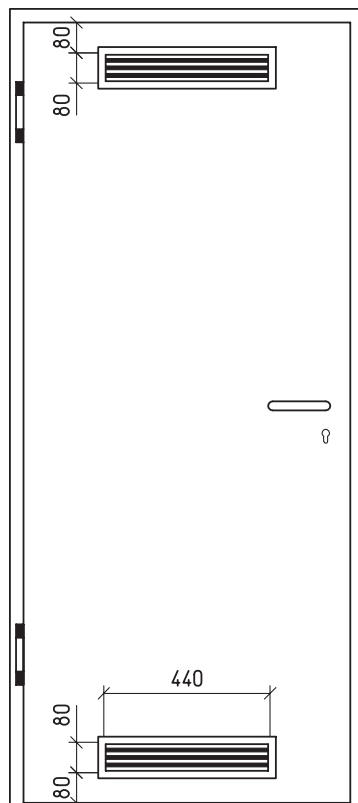

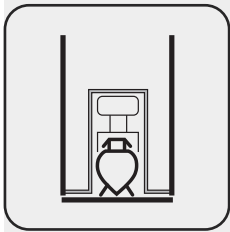

Special equipment

15.15

Requirement-accordant equipment

Grounding strap, stainless steel strike plate

Grounding strap

In order to dissipate an electrostatic charge, which can be transferred to a human by floor coverings or similar things, it is possible to install a so called grounding strap in steel frames. It is necessary to install an earthing cable (PE-conductor) on site.

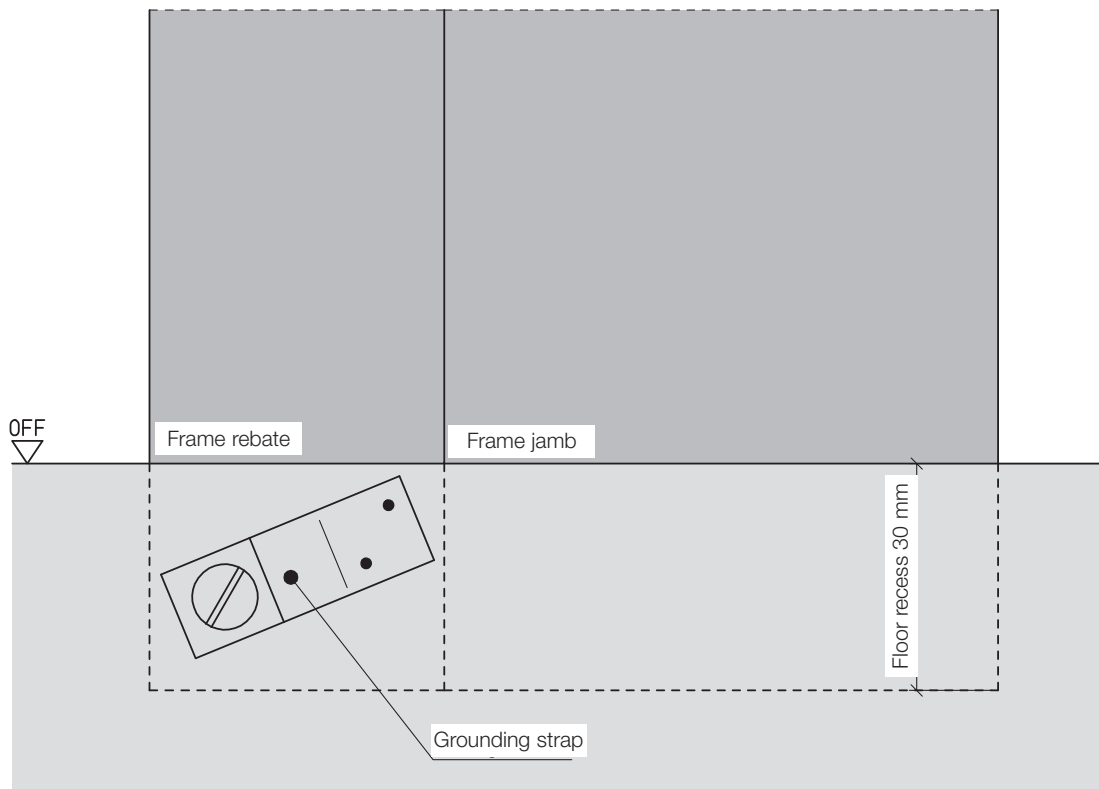

Stainless steel strike plate

In order to prevent a natural abrasive wear of the steel frame in the area of the lock by the latch, it is recommended that also steel frames are equipped with a high-quality stainless steel strike plate. This strike plate will be mounted flush to the steel frame during production.

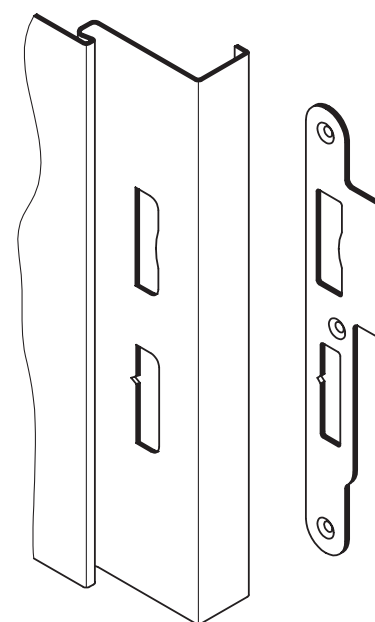

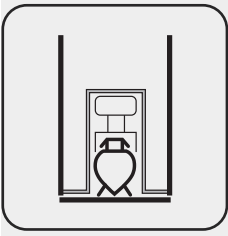

Requirement-accordant equipment

Electromagnets

Electromagnets

Electromagnets are hold-open devices for Fire-Protection closures. In the case of a fire the hold-open device is dismissed by the release unit (smoke detector and control unit). The self-closing of the door is effected by door closers.

According to legal regulations Fire- and Smoke-Protection closures, which due to operating procedures are held open for a certain period of time (e.g. buildings with high visitor traffic), have to be equipped with hold-open devices. In the case of a fire the door leaf has to be released by cutting off the holding current in order to be able to close, with the help of an additional door closer. These hold-open devices, which have to be certified by the DIBt, consist of the **hold-open device** and the **release unit**.

For example DORMA electromagnets in combination with the control unit RMZ-K and the smoke detector RM are approved and certified. The DORMA EM electromagnets differ in casing configuration and hold-open strength. The working current is 24 V direct current.

Depending on the installation situation electromagnets can be mounted on the wall, either underneath the plaster or on top of the plaster, on the floor or on the ceiling. Electromagnets feature on-spot hold-open and a great hold-open strength.

Electromagnets are not part of the Schörghuber delivery set and have to be provided on site.

